

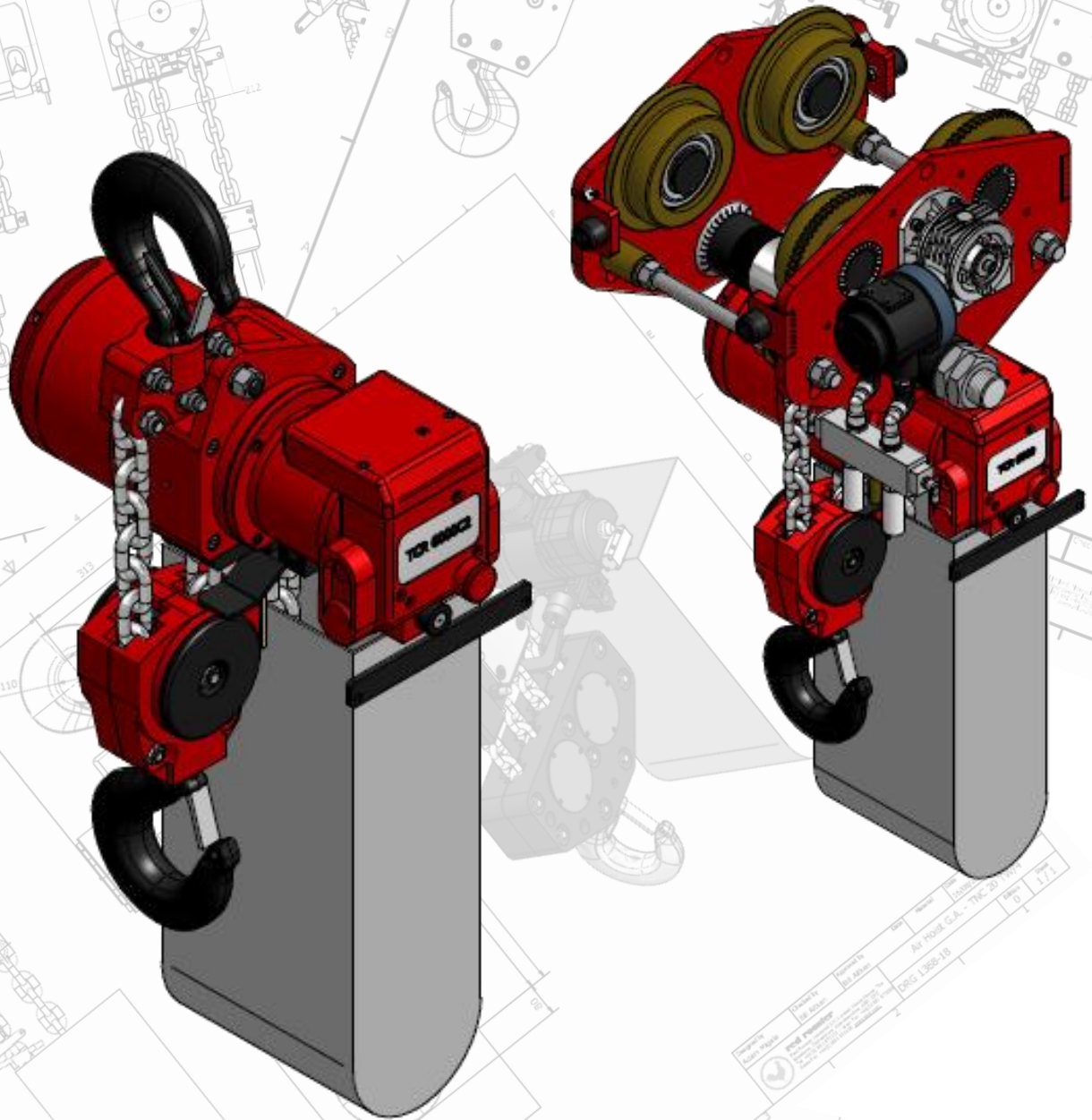

**red rooster**  
INDUSTRIAL (UK) LTD



# PNEUMATIC HOIST AND HOIST & TROLLEY CATALOGUE

[www.rriuk.com](http://www.rriuk.com)



**50 Tonne Hoist & Trolley with 50 metre Height of Lift  
With Special Design Heavy Duty Chain Collector**

**Prepared and Tested at our Oldmeldrum Workshop.**





## INTRODUCTION

At Red Rooster we specialise in the sale, rental, and repair of powered hoists, powered trolleys and winches. The products we supply are tried and tested in offshore applications, heavy engineering, production plants, explosive environments so have been designed for use in the most demanding environments.

We supply a range of pneumatic hoists and powered trolleys from 140 KG to 75 Tonne supplied with cord or a range of pendant controls. We supply most of these standard hoists with ATEX specification (Zone 1 & 2) for use in explosive areas. The brochure shows our range of standard equipment but with our vast experience, in house design and manufacturing facilities we can modify existing products or design to produce a custom made solution. With this flexibility our service is second to none.

Every Red Rooster product is subject to the most rigorous examination and test prior to dispatch. Our testing facilities allow us to carry out dynamic testing up to 30 tonne at our works with static testing up to 400 Tonne.

Red Rooster are specialists in the repair of our own and other manufacturer's hoists. After inspection, a report and quotation is issued to enable the customer to decide on the viability of the repair. Once authorised by the customer, the repair is dealt with promptly and efficiently, to ensure a speedy return.

The company has a certified ISO 9001 Quality system and we are soon to have our Health & Safety system audited for OHSAS18001 accreditation.

We welcome you enquiries for air hoists and powered trolleys for sale, rental, and repair.

Our dedicated sales team will assist you with your enquiry and offer the best solution for your requirements.

Please contact us at:

Oldmeldrum (Aberdeenshire) : +44 (0) 1651 872101  
West Bromwich (West Midlands) : +44 (0) 121 525 4162  
General Enquiries Email : [sales@rriuk.com](mailto:sales@rriuk.com)

Digital Data Sheets and Parts lists are available from our website: [www.rriuk.com](http://www.rriuk.com)

## RED ROOSTER RENTALS

Between our two branches we have over 300 air hoists in our rental fleet, ranging from 125 KG to 50 Tonne with many of these hoists being 25 Tonne and over in capacity. We also stock a vast range of load chain enabling us to match the height of lift required.

The complete range of Air Hoists, Air Trolleys, and Low Headroom Hoists and Trolleys shown in this brochure are available for hire.

We also supply ATEX hoists and trolleys for hire prepared and certified for either Zone I or Zone II. Extra time is required for preparation of ATEX equipment.

### **QUALITY AND RELIABILITY**

The use of only Red Rooster products in our rental fleet ensures we have both the expertise and spare part stockholding to maintain our rental fleet to the highest standard. On completion of every hire the equipment is dismantled, refurbished, and tested prior to going back into store. During preparation for hire the hoist is assembled as per customer requirements, function tested, and final inspection is then carried out, thereby ensuring that all equipment supplied is as per order and in first rate condition.

### **PAY FOR ONLY THE DAYS IN USE**

Within the UK and overseas rental charges do not start until the day 'onsite work commences, or as per agreement at the time of order. On completion of 'on site' work we allow three days free of charge within the UK to facilitate return (Negotiable outside the UK)

### **SERVICE YOU CAN TRUST**

We always endeavour to meet the required delivery 'no matter how challenging', technical support is always available, equipment tailored to meet you requirements, and in the unlikely event of a problem advice, spares, service, or a replacement unit is available at short notice.

### **HIRE RATES**

We structure our hire rates to take into account the length of hire and quantity of hoists so we can offer the most competitive rates possible. This along with our pay for days in use policy means you will always get value for money.

Please contact: Susan or Adrian at Oldmeldrum : +44 (0) 1651 872101  
Andy at West Bromwich: +44 (0) 121 525 4162  
General Enquiries Email: [sales@rriuk.com](mailto:sales@rriuk.com)





# CONTENTS

***Pneumatic Hoists***

***Pneumatic Hoist & Trolley***

***Low Headroom Pneumatic Hoist & Trolley***

***Various Designs***

***Special Designs***



**red rooster**  
INDUSTRIAL (UK) LTD

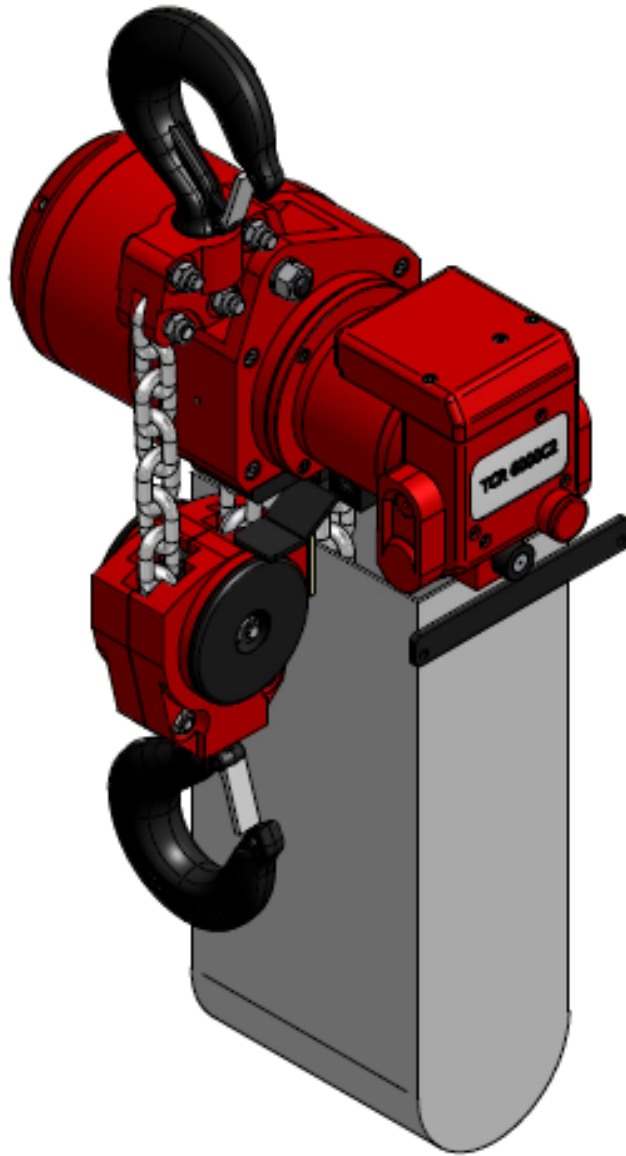

# PNEUMATIC HOISTS

[www.rriuk.com](http://www.rriuk.com)

*An ideal workbench hoist. Light weight and portable, the unit weighs less than 10kg, has a maximum height of lift of 2 metres and operates at 100% duty cycle. Red Rooster pneumatic hoists comply with the European Machinery Directive and are CE marked. Our ISO9001:2008 Quality System is accredited by L.R.Q.A.*

**Standard Hoist Features:**

- Toku rotary vane motor.
- Handle mounted pendant for one handed operation.
- Failsafe automatic internal disc brake
- Variable Speed
- Self Winding Galvanised Cable
- Cast Aluminium housing.
- Internal silencing down to 75 dBA
- Alloy safety swivel hooks c/w safety catch.

**Available Options:**

- Special paint systems
- Air service units
- Festoon systems

MODEL	WLL	LIFTING SPEED WITH LOAD	LIFTING SPEED WITHOUT LOAD	AIR CONSUMPTION LIFTING	AIR CONNECTION	MINIMUM HOSE DIAM.
	140kg	11.0 m/min	15.0 m/min	8 l/sec	3/8" BSP	13mm HOSE
TMM-140A	WORKING PRESSURE		FALLS		WEIGHT	
	6 bar		1 (Cable)		9.5 kg	

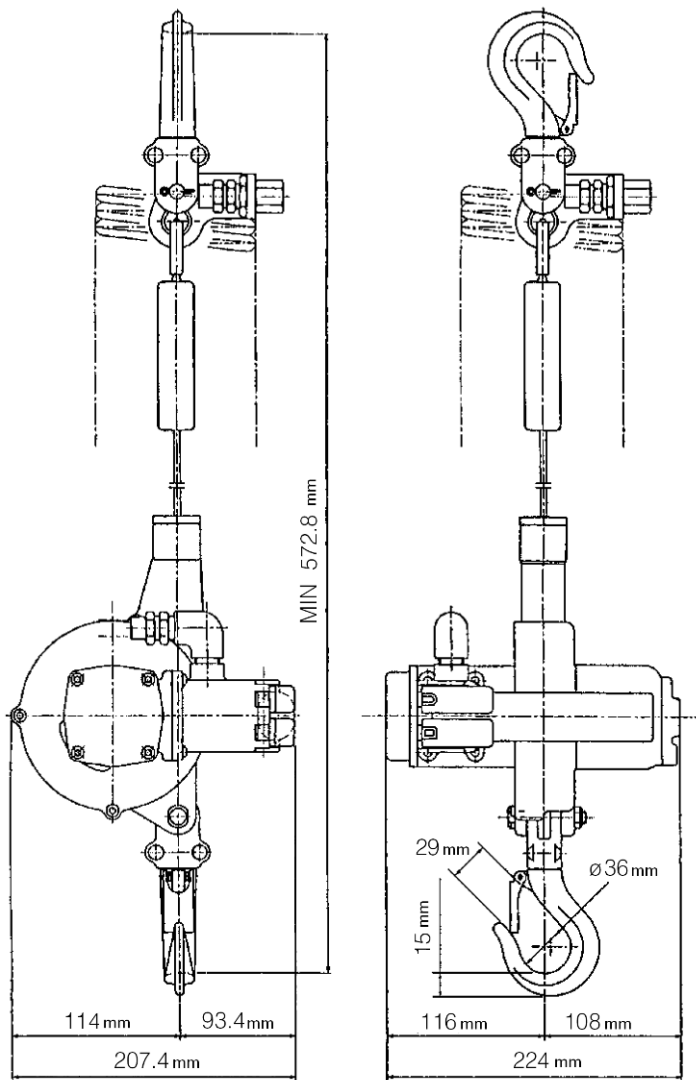

All measurements are in mm

For quotation purposes only. Not drawn to scale. This drawing may not include all options offered on the quotation



### Standard Hoist Features:

- Toku rotary vane motor
- Robust epicyclic gearbox (grease filled and sealed).
- Failsafe automatic internal disc brake
- Choice of pull cord or pendant control
- Mechanical upper & lower limit switches
- Cast steel housing
- Internal silencing down to 75 dBA
- Alloy safety swivel hooks c/w safety catch
- Load chain of European manufacture EN818/1-7
- Automatic, adjustable load limiter

### Available Options:

- Marine Specification
- Special paint systems
- Corrosion protection
- ATEX specification ZONE 1 & 2
- Chain collectors (PVC, Galvanised or Stainless Steel)
- Air Service Units
- Festoon Systems
- Radio Control
- Main air shut off valve

MODEL	WLL	LIFTING SPEED WITH LOAD	LIFTING SPEED WITHOUT LOAD	AIR CONSUMPTION LIFTING	LOWERING SPEED WITH LOAD (M/MIN)	AIR CONSUMPTION LOWERING
TCR-250-A	250kg	9.3 m/min	19.0 m/min	13 l/sec	17.9	15 l/sec
TCS-500-A	500kg	17.0 m/min	43.0 m/min	34 l/sec	17.9	15 l/sec
	AIR CONNECTION	MINIMUM HOSE DIAM.	WORKING PRESSURE	CHAIN FALLS	WEIGHT WITH 3M HOL	WEIGHT PER ADDITIONAL METRE HOL
TCR-250-A	3/8" BSP	3/8" HOSE	6 bar	1	7.0kg	0.35kg
TCS-500-A	1/2" BSP	13mm HOSE	6 bar	1	15.9kg	0.35kg

**TCR-250-A**

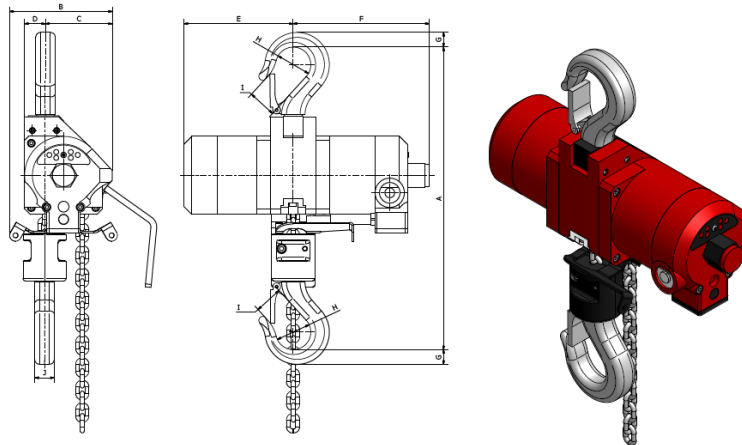

Model	A	B	C	D	E	F	G	HØ	I	J
TCR-250-A	310	105	69	22	112	140	15	36	22	20

**TCS-500-A**

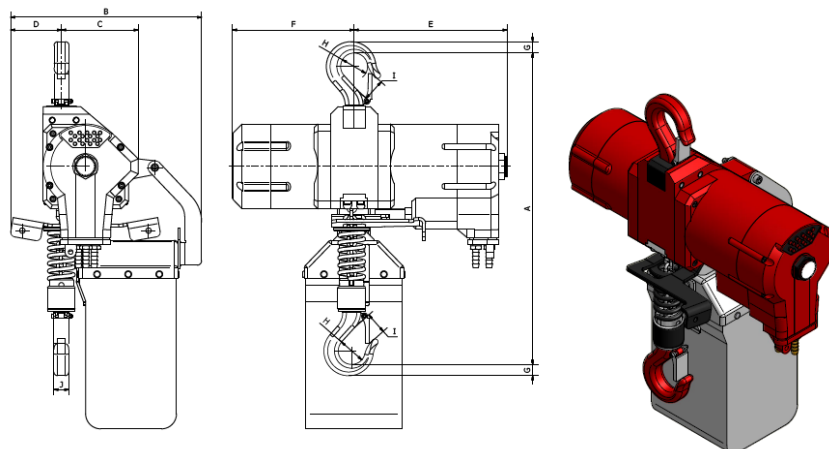

Model	A	B	C	D	E	F	G	HØ	I	J
TCS-500	415	255	103	68	205	163	15	35	22	22

For quotation purposes only. Not drawn to scale. This drawing may not include all options offered on the quotation

**Standard Hoist Features:**

- Toku rotary vane motor
- Robust epicyclic gearbox (grease filled and sealed).
- Failsafe automatic internal disc brake
- Choice of pull cord or pendant control
- Mechanical upper & lower limit switches
- Cast steel housing
- Internal silencing down to 75 dBA
- Alloy safety swivel hooks c/w safety catch
- Load chain of European manufacture EN818/1-7
- Automatic, adjustable load limiter

**Available Options:**

- Marine Specification
- Special paint systems
- Corrosion protection
- ATEX specification ZONE 1 & 2
- Chain collectors (PVC, Galvanised or Stainless Steel)
- Air Service Units
- Festoon Systems
- Radio Control
- Main air shut off valve

MODEL	WLL	LIFTING SPEED WITH LOAD	LIFTING SPEED WITHOUT LOAD	AIR CONSUMPTION LIFTING	LOWERING SPEED WITH LOAD (M/MIN)	AIR CONSUMPTION LOWERING
	250kg	10.5 m/min	16.0 m/min	25 l/sec	17.9	27 l/sec
TCR-250	AIR CONNECTION	MINIMUM HOSE DIAM.	WORKING PRESSURE	CHAIN FALLS	WEIGHT WITH 3M HOL	WEIGHT PER ADDITIONAL METRE HOL
	½" BSP	½" HOSE	6 bar	1	31.1kg	0.7kg

MODEL	WLL	LIFTING SPEED WITH LOAD	LIFTING SPEED WITHOUT LOAD	AIR CONSUMPTION LIFTING	LOWERING SPEED WITH LOAD (M/MIN)	AIR CONSUMPTION LOWERING
	500kg	10.5 m/min	16.0 m/min	25 l/sec	17.9	27 l/sec
TCR-500	AIR CONNECTION	MINIMUM HOSE DIAM.	WORKING PRESSURE	CHAIN FALLS	WEIGHT WITH 3M HOL	WEIGHT PER ADDITIONAL METRE HOL
	½" BSP	½" HOSE	6 bar	1	31.1kg	0.7kg

MODEL	WLL	LIFTING SPEED WITH LOAD	LIFTING SPEED WITHOUT LOAD	AIR CONSUMPTION LIFTING	LOWERING SPEED WITH LOAD	AIR CONSUMPTION LOWERING
	1000kg	5.3 m/min	9.5 m/min	25 l/sec	9.0 m/min	27 l/sec
TCR-1000C2	AIR CONNECTION	MINIMUM HOSE DIAM.	WORKING PRESSURE	CHAIN FALLS	WEIGHT WITH 3M HOL	WEIGHT PER ADDITIONAL METRE HOL
	½" BSP	½" HOSE	6 bar	2	35.2kg	1.1kg

For quotation purposes only. Not drawn to scale. This drawing may not include all options offered on the quotation



**TCR-250**

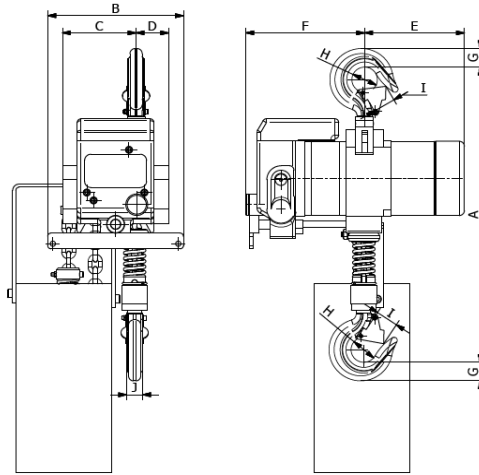

Model	A	B	C	D	E	F	G	HØ	I	J
TCR-250	460	212	115	51	156	186	29	40	29	25

**TCR-500**

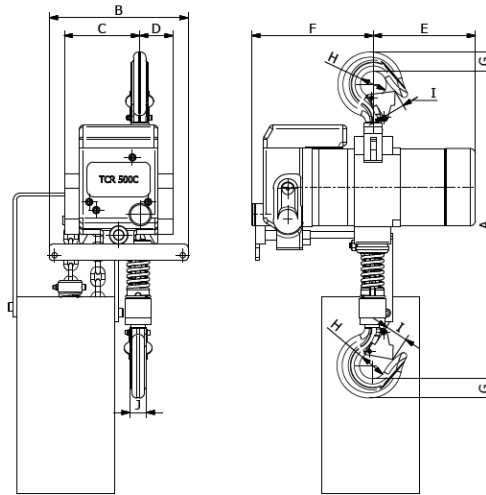

Model	A	B	C	D	E	F	G	HØ	I	J
TCR-500	460	212	115	51	156	186	29	40	29	25

**TCR-1000C2**

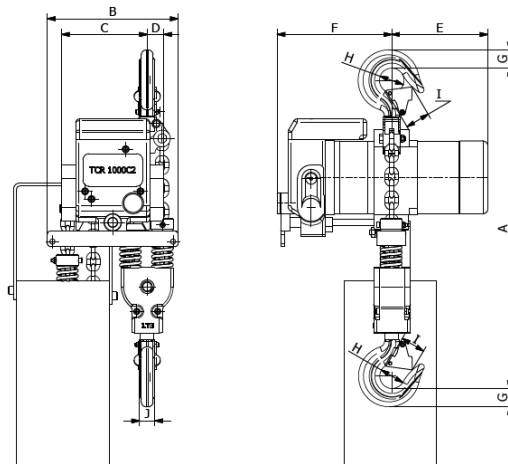

Model	A	B	C	D	E	F	G	HØ	I	J
TCR-1000C2	519	212	139	27	156	186	29	40	29	25

For quotation purposes only. Not drawn to scale. This drawing may not include all options offered on the quotation





**Standard Hoist Features:**

- Toku rotary vane motor
- Robust epicyclic gearbox (grease filled and sealed).
- Failsafe automatic internal disc brake
- Choice of pull cord or pendant control
- Mechanical upper & lower limit switches
- Cast steel housing
- Internal silencing down to 75 dBA
- Alloy safety swivel hooks c/w safety catch
- Load chain of European manufacture EN818/1-7
- Automatic, adjustable load limiter

**Available Options:**

- Marine Specification
- Special paint systems
- Corrosion protection
- ATEX specification ZONE 1 & 2
- Chain collectors (PVC, Galvanised or Stainless Steel)
- Air Service Units
- Festoon Systems
- Radio Control
- Main air shut off valve

MODEL	WLL	LIFTING SPEED WITH LOAD	LIFTING SPEED WITHOUT LOAD	AIR CONSUMPTION LIFTING	LOWERING SPEED WITH LOAD	AIR CONSUMPTION LOWERING
	1000kg	6.0 m/min	11.3 m/min	25 l/sec	10.3 m/min	28 l/sec
TCR-1000C	AIR CONNECTION	MINIMUM HOSE DIAM.	WORKING PRESSURE	CHAIN FALLS	WEIGHT WITH 3M HOL	WEIGHT PER ADDITIONAL METRE HOL
	½" BSP	½" HOSE	6 bar	1	34kg	1.1kg

MODEL	WLL	LIFTING SPEED WITH LOAD	LIFTING SPEED WITHOUT LOAD	AIR CONSUMPTION LIFTING	LOWERING SPEED WITH LOAD	AIR CONSUMPTION LOWERING
	2000kg	3.0 m/min	5.7 m/min	25 l/sec	5.2 m/min	30 l/sec
TCR-2000C2	AIR CONNECTION	MINIMUM HOSE DIAM.	WORKING PRESSURE	CHAIN FALLS	WEIGHT WITH 3M HOL	WEIGHT PER ADDITIONAL METRE HOL
	½" BSP	½" HOSE	6 bar	2	39.7kg	2.2kg

MODEL	WLL	LIFTING SPEED WITH LOAD	LIFTING SPEED WITHOUT LOAD	AIR CONSUMPTION LIFTING	LOWERING SPEED WITH LOAD	AIR CONSUMPTION LOWERING
	3000kg	2.8 m/min	5.7 m/min	33 l/sec	4.6 m/min	43 l/sec
TCR-3000C	AIR CONNECTION	MINIMUM HOSE DIAM.	WORKING PRESSURE	CHAIN FALLS	WEIGHT WITH 3M HOL	WEIGHT PER ADDITIONAL METRE HOL
	½" BSP	¾" HOSE	6 bar	1	69 kg	2.7 kg

For quotation purposes only. Not drawn to scale. This drawing may not include all options offered on the quotation



**TCR-1000C**

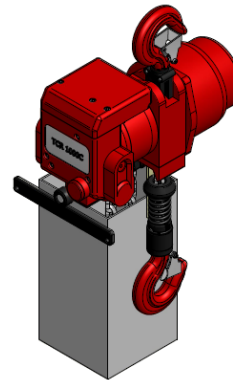
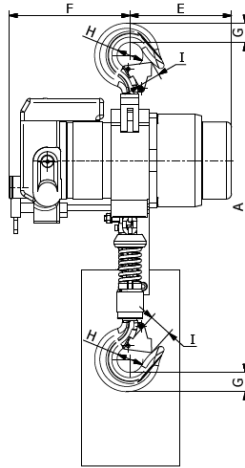
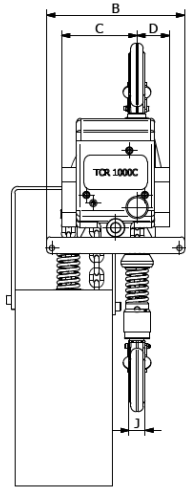

Model	A	B	C	D	E	F	G	HØ	I	J
TCR-1000C	485	212	116	40	156	186	29	40	29	25

**TCR-2000C2**

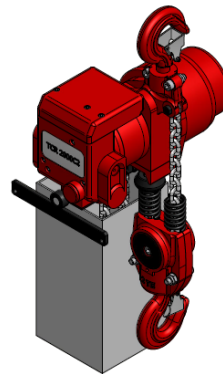
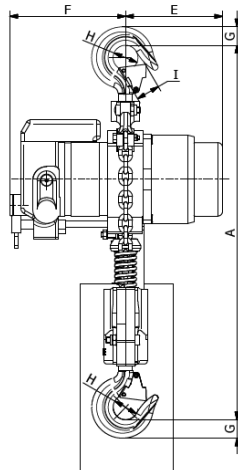
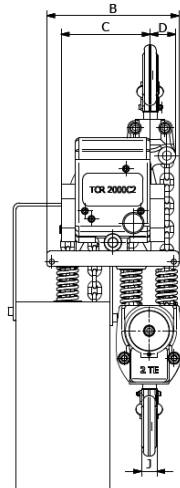

Model	A	B	C	D	E	F	G	HØ	I	J
TCR-2000C2	595	212	143	50	156	186	37	45	29	30

**TCR-3000C**

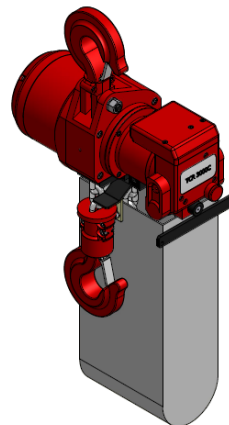
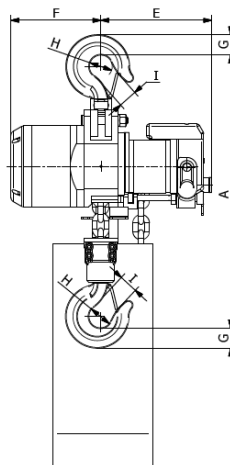
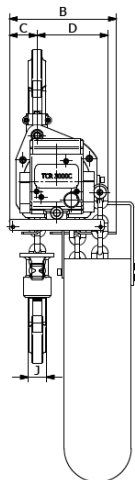

Model	A	B	C	D	E	F	G	HØ	I	J
TCR-3000C	563	240	62	159	248	201	45	50	34	35

For quotation purposes only. Not drawn to scale. This drawing may not include all options offered on the quotation



**Standard Hoist Features:**

- Toku rotary vane motor
- Robust epicyclic gearbox (grease filled and sealed).
- Failsafe automatic internal disc brake
- Choice of pull cord or pendant control
- Mechanical upper & lower limit switches
- Cast steel housing
- Internal silencing down to 75 dBA
- Alloy safety swivel hooks c/w safety catch
- Load chain of European manufacture EN818/1-7
- Automatic, adjustable load limiter

**Available Options:**

- Marine Specification
- Special paint systems
- Corrosion protection
- ATEX specification ZONE 1 & 2
- Chain collectors (PVC, Galvanised or Stainless Steel)
- Air Service Units
- Festoon Systems
- Radio Control
- Main air shut off valve

MODEL	WLL	LIFTING SPEED WITH LOAD	LIFTING SPEED WITHOUT LOAD	AIR CONSUMPTION LIFTING	LOWERING SPEED WITH LOAD	AIR CONSUMPTION LOWERING
	6000kg	1.4 m/min	2.9 m/min	33 l/sec	2.3 m/min	43 l/sec
TCR-6000C2	AIR CONNECTION	MINIMUM HOSE DIAM.	WORKING PRESSURE	CHAIN FALLS	WEIGHT WITH 3M HOL	WEIGHT PER ADDITIONAL METRE HOL
	1/2" BSP	3/4" HOSE	6 bar	2	91 kg	5.4 kg

MODEL	WLL	LIFTING SPEED WITH LOAD	LIFTING SPEED WITHOUT LOAD	AIR CONSUMPTION LIFTING	LOWERING SPEED WITH LOAD	AIR CONSUMPTION LOWERING
	9000kg	0.9 m/min	1.9 m/min	33 l/sec	1.5 m/min	43 l/sec
TCR-9000/3	AIR CONNECTION	MINIMUM HOSE DIAM.	WORKING PRESSURE	CHAIN FALLS	WEIGHT WITH 3M HOL	WEIGHT PER ADDITIONAL METRE HOL
	1/2" BSP	3/4" HOSE	6 bar	3	150 kg	8.1 kg

MODEL	WLL	LIFTING SPEED WITH LOAD	LIFTING SPEED WITHOUT LOAD	AIR CONSUMPTION LIFTING	LOWERING SPEED WITH LOAD	AIR CONSUMPTION LOWERING
	12,000kg	0.6 m/min	1.4 m/min	33 l/sec	1.1 m/min	43 l/sec
TCR 12000/4	AIR CONNECTION	MINIMUM HOSE DIAM.	WORKING PRESSURE	CHAIN FALLS	WEIGHT WITH 3M HOL	WEIGHT PER ADDITIONAL METRE HOL
	1/2" BSP	3/4" HOSE	6 bar	4	170 kg	10.8 kg

For quotation purposes only. Not drawn to scale. This drawing may not include all options offered on the quotation





**TCR-6000/2**

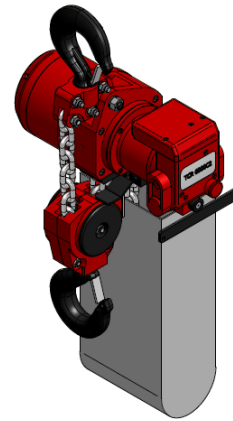
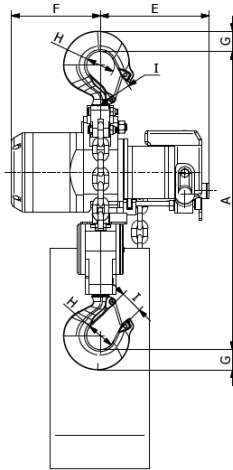
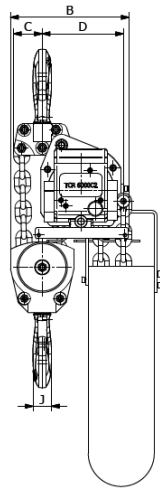

Model	A	B	C	D	E	F	G	HØ	I	J
TCR-6000C2	695	270	65	185	247	202	49	65	42	42

**TCR-9000/3**

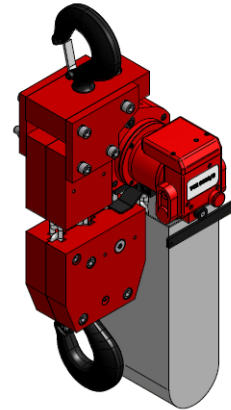
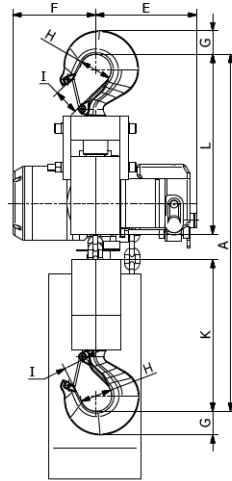
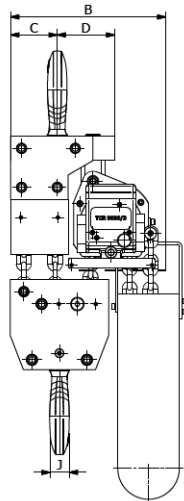

Model	A	B	C	D	E	F	G	HØ	I	J	K	L
TCR-9000/3	842	378	114	140	247	202	60	75	53	42	370	439

**TCR-12000/4**

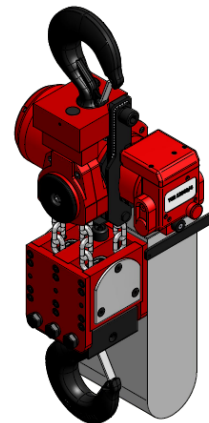
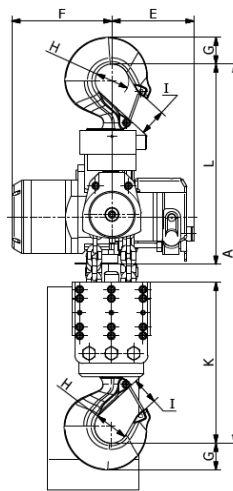
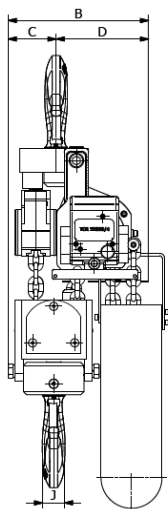

Model	A	B	C	D	E	F	G	HØ	I	J	K	L
TCR12000/4	950	346	118	228	202	247	67	84	58	52	396	493

For quotation purposes only. Not drawn to scale. This drawing may not include all options offered on the quotation



**Standard Hoist Features:**

- Toku rotary vane motor
- Robust epicyclic gearbox (grease filled and sealed).
- Failsafe automatic internal disc brake
- Choice of pull cord or pendant control
- Mechanical upper & lower limit switches
- Cast steel housing
- Internal silencing down to 75 dBA
- Alloy safety swivel hooks c/w safety catch
- Load chain of European manufacture EN818/1-7
- Automatic, adjustable load limiter

**Available Options:**

- Marine Specification
- Special paint systems
- Corrosion protection
- ATEX specification ZONE 1 & 2
- Chain collectors (PVC, Galvanised or Stainless Steel)
- Air Service Units
- Festoon Systems
- Radio Control
- Main air shut off valve

MODEL	WLL	LIFTING SPEED WITH LOAD	LIFTING SPEED WITHOUT LOAD	AIR CONSUMPTION LIFTING	LOWERING SPEED WITH LOAD	AIR CONSUMPTION LOWERING
	10,000kg	1.5 m/min	2.5 m/min	90 l/sec	2.3 m/min	100 l/sec
TNC 10 TW LPE	AIR CONNECTION	MINIMUM HOSE DIAM.	WORKING PRESSURE	CHAIN FALLS	WEIGHT WITH 3M HOL	WEIGHT PER ADDITIONAL METRE HOL
	1" BSP	1" HOSE	6 bar	2	190 kg	11.4 kg

MODEL	WLL	LIFTING SPEED WITH LOAD	LIFTING SPEED WITHOUT LOAD	AIR CONSUMPTION LIFTING	LOWERING SPEED WITH LOAD	AIR CONSUMPTION LOWERING
	15,000kg	0.5 m/min	1.1 m/min	33 l/sec	0.9 m/min	43 l/sec
TCR 15000/5	AIR CONNECTION	MINIMUM HOSE DIAM.	WORKING PRESSURE	CHAIN FALLS	WEIGHT WITH 3M HOL	WEIGHT PER ADDITIONAL METRE HOL
	1/2" BSP	3/4" HOSE	6 bar	5	210 kg	13.5 kg

MODEL	WLL	LIFTING SPEED WITH LOAD	LIFTING SPEED WITHOUT LOAD	AIR CONSUMPTION LIFTING	LOWERING SPEED WITH LOAD	AIR CONSUMPTION LOWERING
	15,000kg	1.0 m/min	1.6 m/min	90 l/sec	1.5 m/min	100 l/sec
TNC15 TW/3	AIR CONNECTION	MINIMUM HOSE DIAM.	WORKING PRESSURE	CHAIN FALLS	WEIGHT WITH 3M HOL	WEIGHT PER ADDITIONAL METRE HOL
	1" BSP	1" HOSE	6 bar	3	300 kg	17.1 kg

For quotation purposes only. Not drawn to scale. This drawing may not include all options offered on the quotation



**TNC10TWLPE**

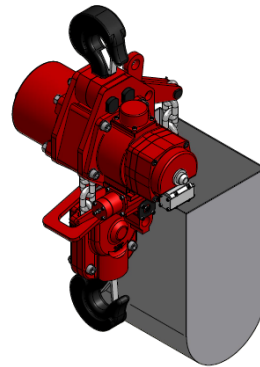
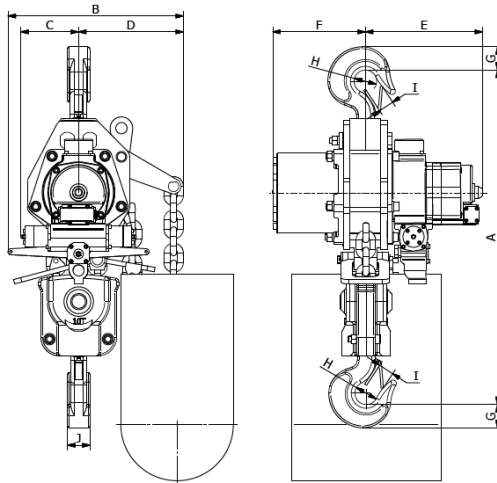

Model	A	B	C	D	E	F	G	HØ	I	J
TNC 10 TW LPE	890	467	154	279	313	247	62	60	40	55

**TCR15000/5**

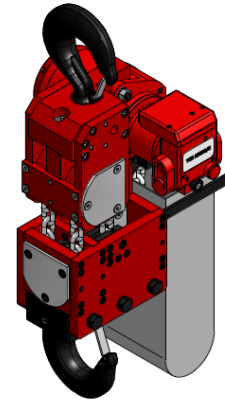
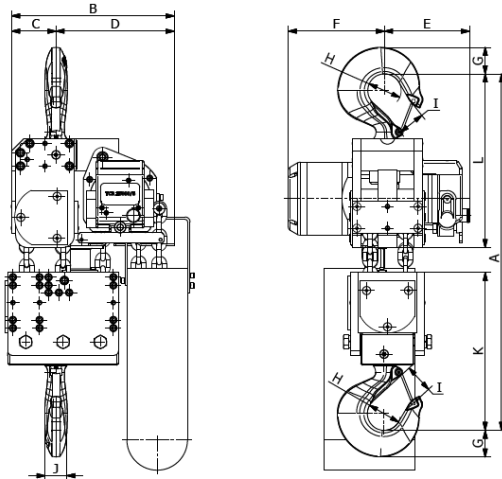

Model	A	B	C	D	E	F	G	HØ	I	J	K	L
TCR15000/5	950	403	110	293	211	238	67	84	58	52	391	431

**TNC15TWI3**

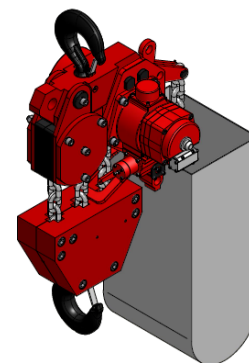
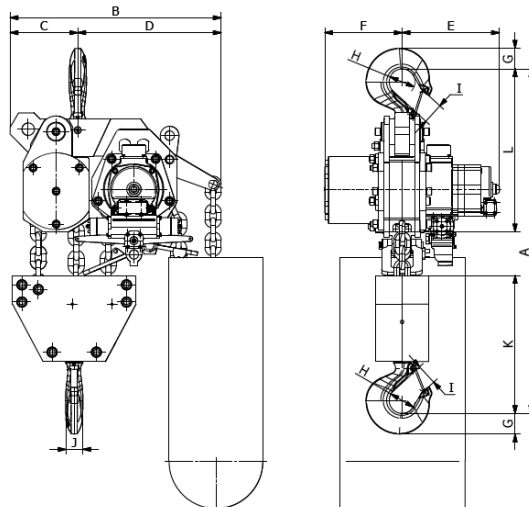

Model	A	B	C	D	E	F	G	HØ	I	J	K	L
TNC15 TW/3	1100	676	217	459	312	248	67	84	58	52	441	521

For quotation purposes only. Not drawn to scale. This drawing may not include all options offered on the quotation





**Standard Hoist Features:**

- Toku rotary vane motor
- Robust epicyclic gearbox (grease filled and sealed).
- Failsafe automatic internal disc brake
- Choice of pull cord or pendant control
- Mechanical upper & lower limit switches
- Cast steel housing
- Internal silencing down to 75 dBA
- Alloy safety swivel hooks c/w safety catch
- Load chain of European manufacture EN818/1-7
- Automatic, adjustable load limiter

**Available Options:**

- Marine Specification
- Special paint systems
- Corrosion protection
- ATEX specification ZONE 1 & 2
- Chain collectors (PVC, Galvanised or Stainless Steel)
- Air Service Units
- Festoon Systems
- Radio Control
- Main air shut off valve

MODEL	WLL	LIFTING SPEED WITH LOAD	LIFTING SPEED WITHOUT LOAD	AIR CONSUMPTION LIFTING	LOWERING SPEED WITH LOAD	AIR CONSUMPTION LOWERING
	20,000kg	0.75 m/min	1.25 m/min	90 l/sec	1.15 m/min	100 l/sec
TNC 20 TW/4	AIR CONNECTION	MINIMUM HOSE DIAM.	WORKING PRESSURE	CHAIN FALLS	WEIGHT WITH 3M HOL	WEIGHT PER ADDITIONAL METRE HOL
	1" BSP	1" HOSE	6 bar	4	470 kg	22.8 kg

MODEL	WLL	LIFTING SPEED WITH LOAD	LIFTING SPEED WITHOUT LOAD	AIR CONSUMPTION LIFTING	LOWERING SPEED WITH LOAD	AIR CONSUMPTION LOWERING
	25,000kg	0.6 m/min	1.0 m/min	90 l/sec	0.7 m/min	100 l/sec
TNC 25 TW LPE	AIR CONNECTION	MINIMUM HOSE DIAM.	WORKING PRESSURE	CHAIN FALLS	WEIGHT WITH 3M HOL	WEIGHT PER ADDITIONAL METRE HOL
	1" BSP	1" HOSE	6 bar	2	460 kg	21.8 kg

For quotation purposes only. Not drawn to scale. This drawing may not include all options offered on the quotation



**TNC20TW/4**

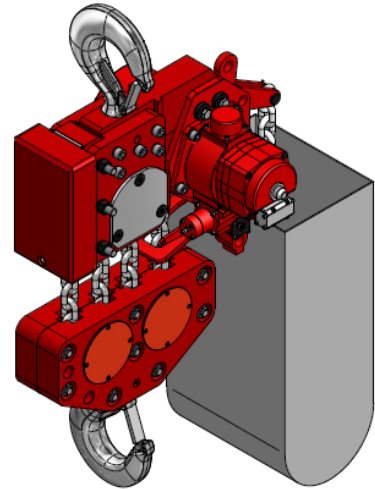
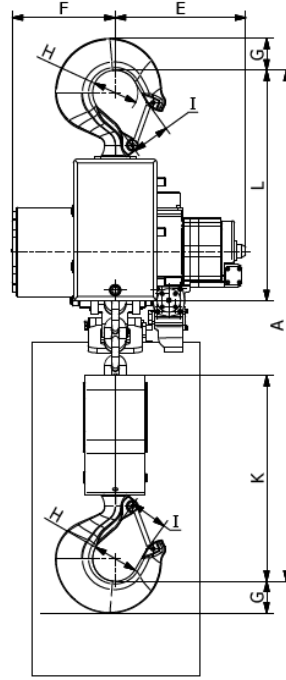
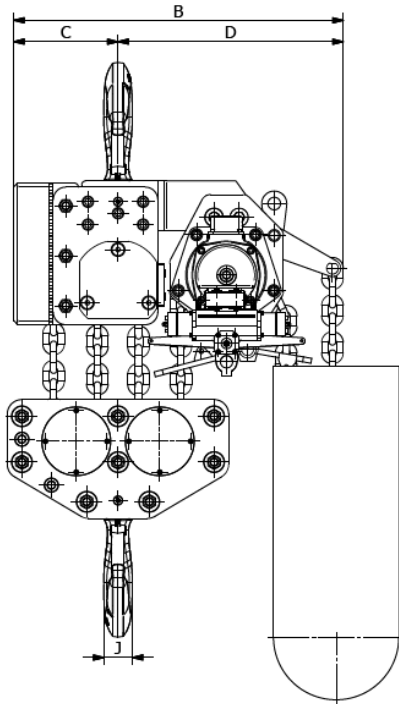

Model	A	B	C	D	E	F	G	HØ	I	J	K	L
TNC 20 TW/4	1120	789	250	539	313	247	80	110	78	64	493	553

**TNC25TWLPE**

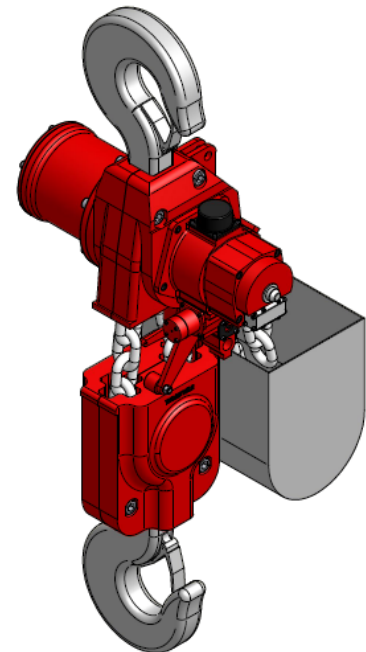
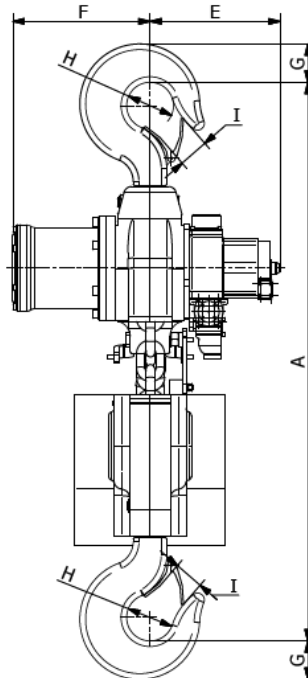
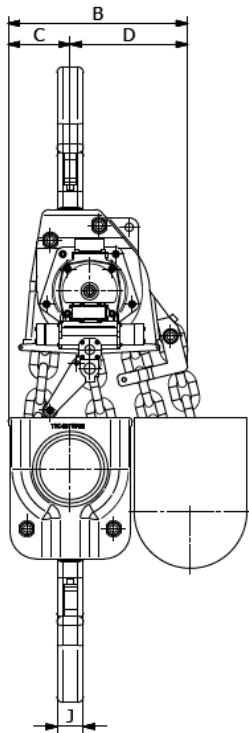

Model	A	B	C	D	E	F	G	HØ	I	J
TNC 25 TW LPE	1400	478	165	313	346	365	103	125	80	82

For quotation purposes only. Not drawn to scale. This drawing may not include all options offered on the quotation



### Standard Hoist Features:

- Toku rotary vane motor
- Robust epicyclic gearbox (grease filled and sealed).
- Failsafe automatic internal disc brake
- Choice of pull cord or pendant control
- Mechanical upper & lower limit switches
- Cast steel housing
- Internal silencing down to 75 dBA
- Alloy safety swivel hooks c/w safety catch
- Load chain of European manufacture EN818/1-7
- Automatic, adjustable load limiter

### Available Options:

- Marine Specification
- Special paint systems
- Corrosion protection
- ATEX specification ZONE 1 & 2
- Chain collectors (PVC, Galvanised or Stainless Steel)
- Air Service Units
- Festoon Systems
- Radio Control
- Main air shut off valve

MODEL	WLL	LIFTING SPEED WITH LOAD	LIFTING SPEED WITHOUT LOAD	AIR CONSUMPTION LIFTING	LOWERING SPEED WITH LOAD	AIR CONSUMPTION LOWERING
	37,500kg	0.35 m/min	0.6 m/min	90 l/sec	0.5 m/min	100 l/sec
TNC 37.5 TW/3	AIR CONNECTION	MINIMUM HOSE DIAM.	WORKING PRESSURE	CHAIN FALLS	WEIGHT WITH 3M HOL	WEIGHT PER ADDITIONAL METRE HOL
	1" BSP	1" HOSE	6 bar	3	850 kg	32.7 kg

MODEL	WLL	LIFTING SPEED WITH LOAD	LIFTING SPEED WITHOUT LOAD	AIR CONSUMPTION LIFTING	LOWERING SPEED WITH LOAD	AIR CONSUMPTION LOWERING
	50,000kg	0.25 m/min	0.3 m/min	90 l/sec	0.35 m/min	100 l/sec
TNC 50 TW/4 H	AIR CONNECTION	MINIMUM HOSE DIAM.	WORKING PRESSURE	CHAIN FALLS	WEIGHT WITH 3M HOL	WEIGHT PER ADDITIONAL METRE HOL
	1" BSP	1" HOSE	6 bar	4	1110 kg	43.5 kg

For quotation purposes only. Not drawn to scale. This drawing may not include all options offered on the quotation

# TNC37.5/3

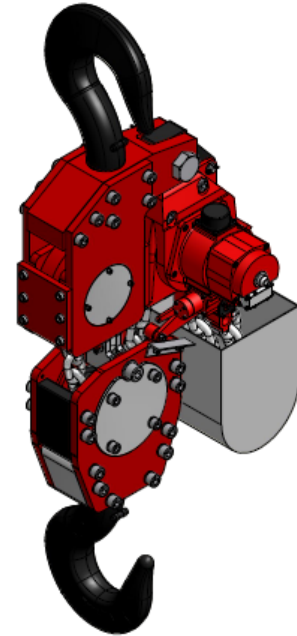
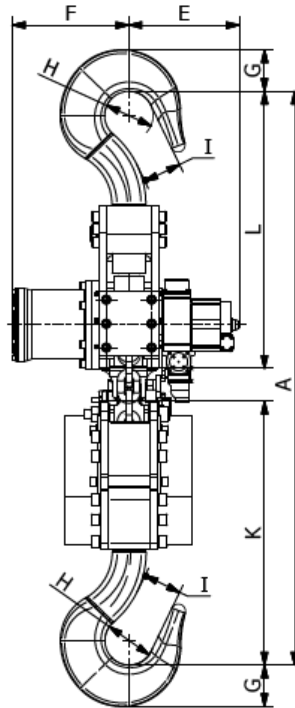
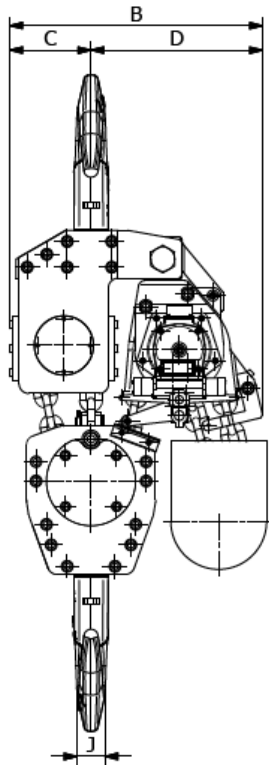

Model	A	B	C	D	E	F	G	HØ	I	J	K	L
TNC 37.5 TW/3	1794	792	225	538	346	366	118	125	90	95	825	867

# TNC50TW/4

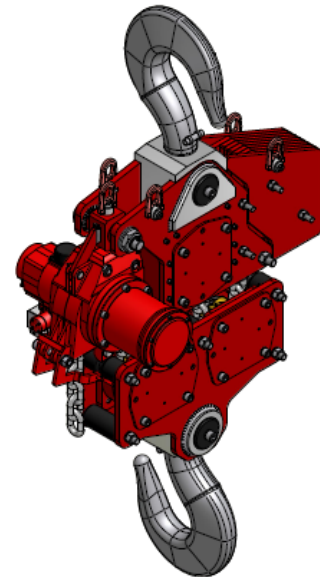
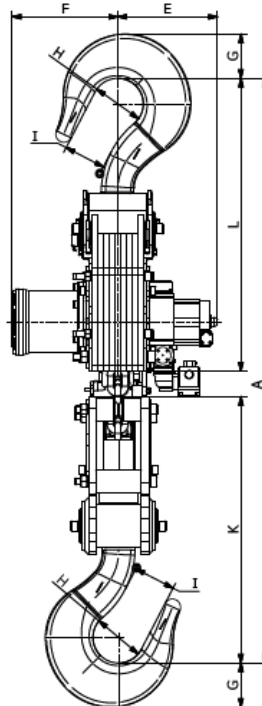
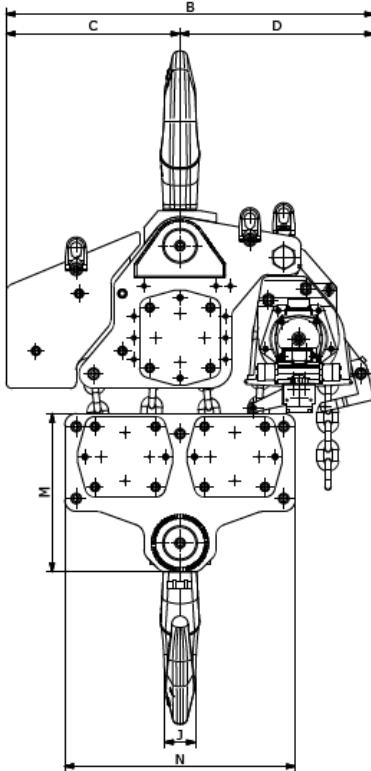

Model	A	B	C	D	E	F	G	HØ	I	J	K	L	M	N
TNC 50TW/4	~2033	1276	603	673	346	366	132	140	100	106	926	1018	550	800

For quotation purposes only. Not drawn to scale. This drawing may not include all options offered on the quotation



**red rooster**  
INDUSTRIAL (UK) LTD

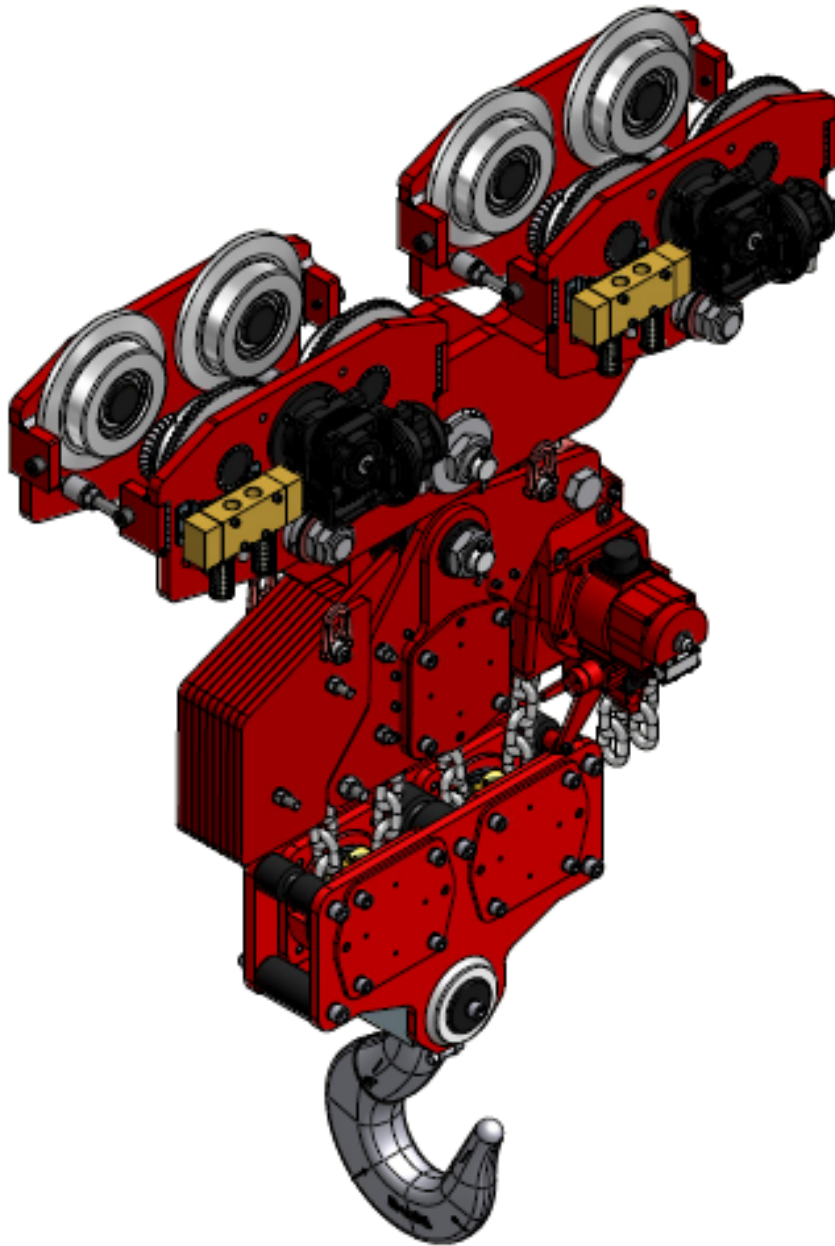

# PNEUMATIC HOIST & TROLLEY RANGE

[www.rriuk.com](http://www.rriuk.com)



**Standard Hoist Features:**

- Toku rotary vane motor.
- Robust epicyclic gearbox (grease filled and sealed).
- Failsafe automatic internal disc brake
- Choice of pendant controls or control stations
- Upper and lower limit switches.
- Cast steel housing.
- Variable speed.
- Internal silencing down to 75 dBA
- Alloy safety swivel hooks c/w safety catch.
- Load chain of European manufacture EN818/1-7
- Automatic, adjustable load limiter
- To suit various Flange Profiles
- Anti Tilt Roller & Anti Drop Plates

**Available Options:**

- Marine specification – stainless steel chain, marine paint
- Chain collectors (P.V.C., galvanised or stainless steel)
- Travel Limits
- Collision Bumpers
- Air service Units
- Festoon systems
- ATEX Specification Zone 1 & 2
- Articulated Trolley
- Low Headroom Units
- Rack & Pinion Drive
- Special Designs
- Radio Remote Control

TCR-500-AT/4	WLL	Chain Falls	Lifting Speed Full Load (m/min)	Lifting Speed Without Load (m/min)	Air Consumption Full Load (l/sec)	Working Pressure	Air Connect	Min. Hose Diam (Bore)	Weight with 3m HOL & Trolley	Weight per metre (HOL)
Hoist	500kg	1	10.5	16.0	25	6 bar	½ Inch BSP	½ Inch	59kg	0.7 kg

TCR-500-AT/4	WLL	Flange Size Range 1 Range 2	Travel Speed m/min	Wheel Material	Min Bend Radius	Number of Wheels	Driven Wheels	Max Air Consumption	Hose ID Trolley (Inches)
Trolley	500kg	56-170 171-300	0-9.5	Steel	1.5	4	2	25 l/sec	0.75

TCR-1000C2-AT/4	WLL	Chain Falls	Lifting Speed Full Load (m/min)	Lifting Speed Without Load (m/min)	Air Consumption Full Load (l/sec)	Working Pressure	Air Connect	Min. Hose Diam (Bore)	Weight with 3m HOL & Trolley	Weight per metre (HOL)
Hoist	1000kg	2	5.3	9.5	25	6 bar	½ Inch BSP	½ Inch	62kg	1.6kg

TCR-1000C2-AT/4	WLL	Flange Size Range 1 Range 2	Travel Speed m/min	Wheel Material	Min Bend Radius	Number of Wheels	Driven Wheels	Max Air Consumption	Hose ID Trolley (Inches)
Trolley	1000kg	56-170 171-300	0-9.5	Steel	1.5	4	2	25 l/sec	0.75

TCR1000-AT/4	WLL	Chain Falls	Lifting Speed Full Load (m/min)	Lifting Speed Without Load (m/min)	Air Consumption Full Load (l/sec)	Working Pressure	Air Connect	Min. Hose Diam (Bore)	Weight with 3m HOL & Trolley	Weight per metre (HOL)
Hoist	1000kg	1	6.0	11.3	25	6 bar	½ Inch BSP	½ Inch	61kg	1.1 kg

TCR1000-AT/4	WLL	Flange Size Range 1 Range 2	Travel Speed m/min	Wheel Material	Min Bend Radius	Number of Wheels	Driven Wheels	Max Air Consumption	Hose ID Trolley (Inches)
Trolley	1000kg	56-170 171-300	0-9.5	Steel	1.5	4	2	25 l/sec	0.75

For quotation purposes only. Not drawn to scale. This drawing may not include all options offered on the quotation

**red rooster** Industrial (UK) Limited.

Nauta House, The Meadows, Oldmeldrum, Aberdeenshire, AB51 0EZ, Tel: 0044 (0) 1651 872101, Fax: 0044 (0) 1651 871405, [sales@riuk.com](mailto:sales@riuk.com), [www.riuk.com](http://www.riuk.com)



**TCR-500-AT14**

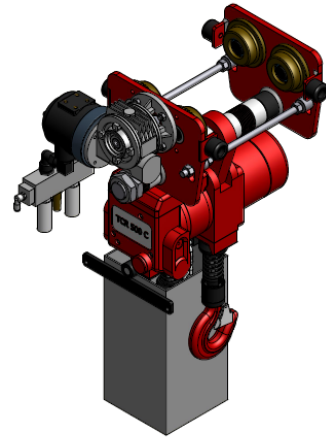
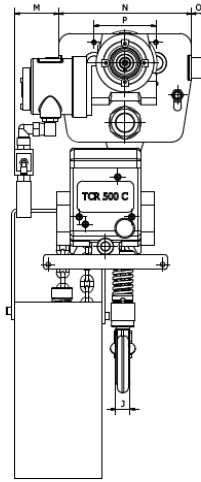
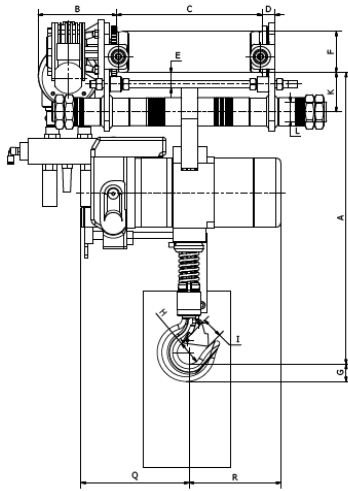

A	B	C	D	E	F $\varnothing$	G	H	I	J	K	L	M	N	O	P	Q	R
~498	135	TBC	22	27	70	30	40	36	25	67	33	75	227	25	106	185	157

**TCR-1000/2-AT14**

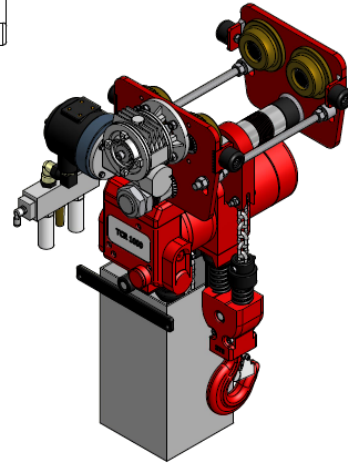
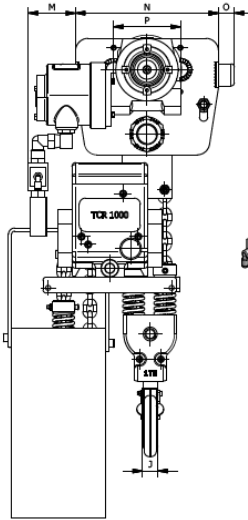
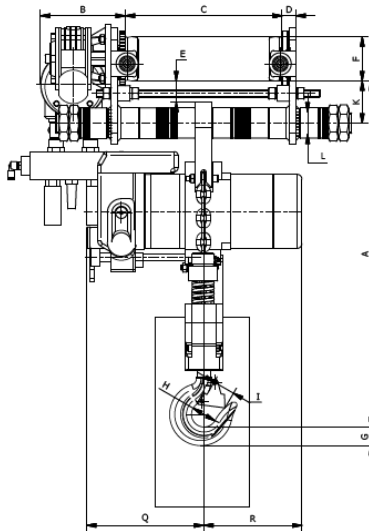

A	B	C	D	E	F $\varnothing$	G	H	I	J	K	L	M	N	O	P	Q	R
~549	~135	TBC	22	27	70	29	40	29	25	67	35	75	227	25	106	186	156

**TCR1000-AT14**

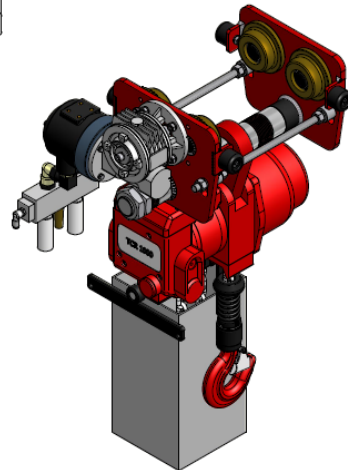
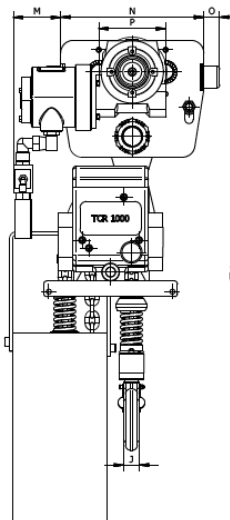
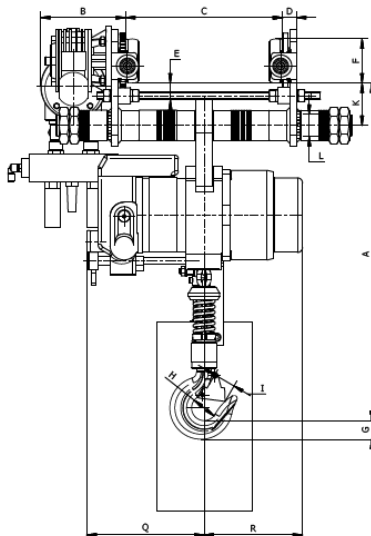

A	B	C	D	E	F $\varnothing$	G	H	I	J	K	L	M	N	O	P	Q	R
~534	~135	TBC	22	27	70	29	40	29	25	67	35	75	227	25	106	186	156

For quotation purposes only. Not drawn to scale. This drawing may not include all options offered on the quotation



**Standard Hoist Features:**

- Toku rotary vane motor.
- Robust epicyclic gearbox (grease filled and sealed).
- Failsafe automatic internal disc brake
- Choice of pendant controls or control stations
- Upper and lower limit switches.
- Cast steel housing.
- Variable speed.
- Internal silencing down to 75 dBA
- Alloy safety swivel hooks c/w safety catch.
- Load chain of European manufacture EN818/1-7
- Automatic, adjustable load limiter
- To suit various Flange Profiles
- Anti Tilt Roller & Anti Drop Plates

**Available Options:**

- Marine specification – stainless steel chain, marine paint
- Chain collectors (P.V.C., galvanised or stainless steel)
- Travel Limits
- Collision Bumpers
- Air service Units
- Festoon systems
- ATEX Specification Zone 1 & 2
- Articulated Trolley
- Low Headroom Units
- Rack & Pinion Drive
- Special Designs
- Radio Remote Control

TCR2000/2-AT/4	WLL	Chain Falls	Lifting Speed Full Load (m/min)	Lifting Speed Without Load (m/min)	Air Consumption Full Load (l/sec)	Working Pressure	Air Connect	Min. Hose Diam (Bore)	Weight with 3m HOL & Trolley	Weight per metre (HOL)
Hoist	2000kg	2	3.0	5.7	25	6 bar	½ Inch BSP	½ Inch	67 kg	2.2 kg

TCR2000/2-AT/4	WLL	Flange Size Range 1 Range 2	Travel Speed m/min	Wheel Material	Min Bend Radius	Number of Wheels	Driven Wheels	Max Air Consumption	Hose ID Trolley (Inches)
Trolley	2000kg	56-170 171-300	0-9.5	Steel	1.5	4	2	25 l/sec	0.75

TCR3000-AT/4	WLL	Chain Falls	Lifting Speed Full Load (m/min)	Lifting Speed Without Load (m/min)	Air Consumption Full Load (l/sec)	Working Pressure	Air Connect	Min. Hose Diam (Bore)	Weight with 3m HOL & Trolley	Weight per metre (HOL)
Hoist	3000kg	1	2.8	5.7	33	6 bar	½ Inch BSP	¾ Inch	110kg	2.7kg

TCR3000-AT/4	WLL	Flange Size Range 1 Range 2	Travel Speed m/min	Wheel Material	Min Bend Radius	Number of Wheels	Driven Wheels	Max Air Consumption	Hose ID Trolley (Inches)
Trolley	3000kg	85-160 160-300	0-9.5	Steel	2.0	4	2	25 l/sec	0.75

TCR6000/2-AT/4	WLL	Chain Falls	Lifting Speed Full Load (m/min)	Lifting Speed Without Load (m/min)	Air Consumption Full Load (l/sec)	Working Pressure	Air Connect	Min. Hose Diam (Bore)	Weight with 3m HOL & Trolley	Weight per metre (HOL)
Hoist	6000kg	2	1.4	2.9	33	6 bar	½ Inch BSP	¾ Inch	153kg	5.4kg

TCR6000/2-AT/4	WLL	Flange Size Range 1 Range 2	Travel Speed m/min	Wheel Material	Min Bend Radius	Number of Wheels	Driven Wheels	Max Air Consumption	Hose ID Trolley (Inches)
Trolley	6000kg	82-170 180-300	0-9.5	Steel	2.5m	4	2	25 l/sec	0.75

For quotation purposes only. Not drawn to scale. This drawing may not include all options offered on the quotation



**TCR-2000/2-AT/4**

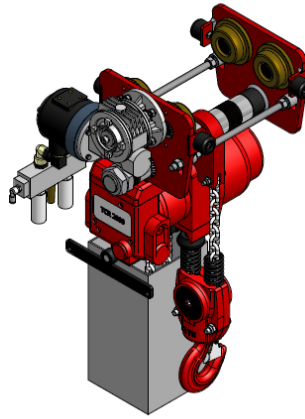
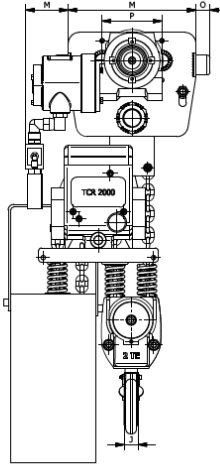
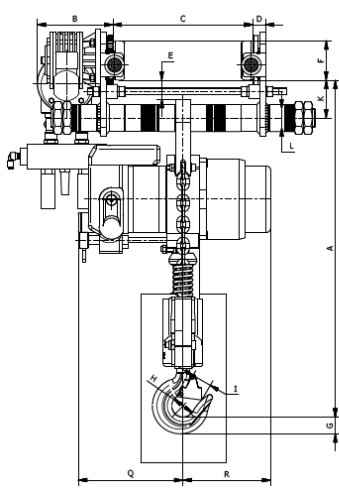

A	B	C	D	E	F∅	G	H	I	J	K	L	M	N	O	P	Q	R
~610	~135	TBC	22	34	70	37	45	29	30	67	35	75	227	25	106	186	156

**TCR-3000-AT/4**

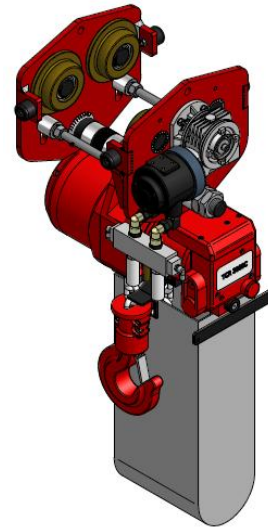
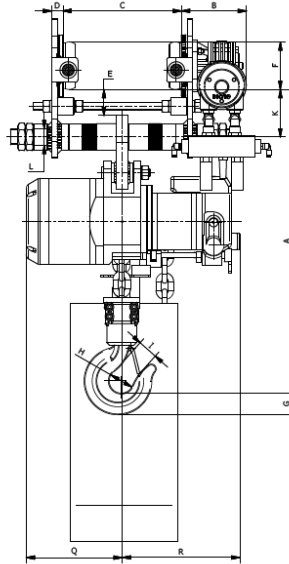
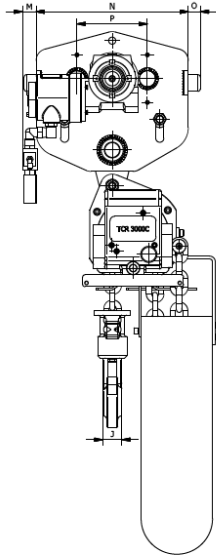

A	B	C	D	E	F∅	G	H	I	J	K	L	M	N	O	P	Q	R
~639	~137	TBA	24	55	100	45	50	34	35	100	35	29	320	25	148	202	247

**TCR6000/2-AT/4**

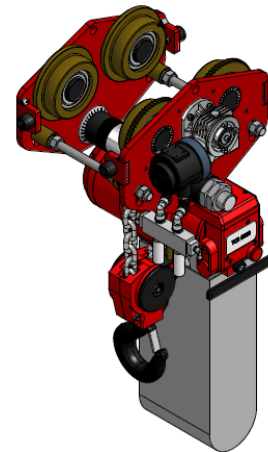
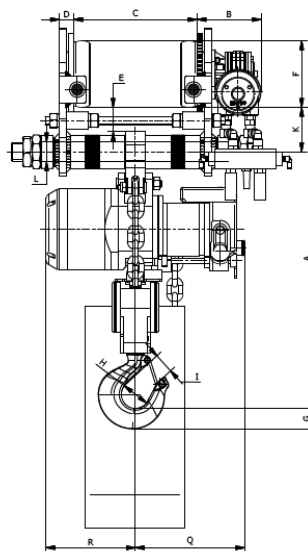
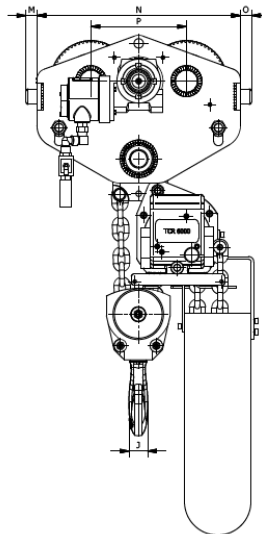

A	B	C	D	E	F∅	G	H	I	J	K	L	M	N	U	P	Q	R
~717	~145	TBA	32	55	150	49	65	42	42	100	45	25	460	25	216	247	202

For quotation purposes only. Not drawn to scale. This drawing may not include all options offered on the quotation



### Standard Hoist Features:

- Toku rotary vane motor.
- Robust epicyclic gearbox (grease filled and sealed).
- Failsafe automatic internal disc brake
- Choice of pendant controls or control stations
- Upper and lower limit switches.
- Cast steel housing.
- Variable speed.
- Internal silencing down to 75 dBA
- Alloy safety swivel hooks c/w safety catch.
- Load chain of European manufacture EN818/1-7
- Automatic, adjustable load limiter
- To suit various Flange Profiles
- Anti Tilt Roller & Anti Drop Plates

### Available Options:

- Marine specification – stainless steel chain, marine paint
- Chain collectors (P.V.C., galvanised or stainless steel)
- Travel Limits
- Collision Bumpers
- Air service Units
- Festoon systems
- ATEX Specification Zone 1 & 2
- Articulated Trolley
- Low Headroom Units
- Rack & Pinion Drive
- Special Designs
- Radio Remote Control

TCR9000/3-AT/4	WLL	Chain Falls	Lifting Speed Full Load (m/min)	Lifting Speed Without Load (m/min)	Air Consumption Full Load (l/sec)	Working Pressure	Air Connect	Min. Hose Diam (Bore)	Weight with 3m HOL & Trolley	Weight per metre (HOL)
Hoist	9000kg	3	0.9	1.9	33	6 bar	½ Inch BSP	¾ Inch	290kg	5.4kg

TCR9000/3-AT/4	WLL	Flange Size Range 1 Range 2	Travel Speed m/min	Wheel Material	Min Bend Radius	Number of Wheels	Driven Wheels	Max Air Consumption	Hose ID Trolley (Inches)
Trolley	9000kg	110-190 200-300	0-9.5	Steel	2.5m	4	2	50 l/sec	0.75

TCR12000/4-AT/4	WLL	Chain Falls	Lifting Speed Full Load (m/min)	Lifting Speed Without Load (m/min)	Air Consumption Full Load (l/sec)	Working Pressure	Air Connect	Min. Hose Diam (Bore)	Weight with 3m HOL & Trolley	Weight per metre (HOL)
Hoist	12000kg	4	0.6	1.4	33	6 bar	½ Inch BSP	¾ Inch	310kg	10.8kg

TCR12000/4-AT/4	WLL	Flange Size Range 1 Range 2	Travel Speed m/min	Wheel Material	Min Bend Radius	Number of Wheels	Driven Wheels	Max Air Consumption	Hose ID Trolley (Inches)
Trolley	12000kg	140-190 200-300	0-9.5	Steel	2.5	4	2	50 l/sec	0.75

TCR15000/5-AT/4	WLL	Chain Falls	Lifting Speed Full Load (m/min)	Lifting Speed Without Load (m/min)	Air Consumption Full Load (l/sec)	Working Pressure	Air Connect	Min. Hose Diam (Bore)	Weight with 3m HOL & Trolley	Weight per metre (HOL)
Hoist	15000kg	5	0.5	1.1	33	6 bar	½" Inch BSP	¾" Inch	360kg	13.5kg

TCR15000/5-AT/4	WLL	Flange Size Range 1 Range 2	Travel Speed m/min	Wheel Material	Min Bend Radius	Number of Wheels	Driven Wheels	Max Air Consumption	Hose ID Trolley (Inches)
Trolley	15000kg	140-190 200-300	0-9.5	Steel	3.0	4	2	80 l/sec	1.0

For quotation purposes only. Not drawn to scale. This drawing may not include all options offered on the quotation





**TCR9000/3-AT/4**

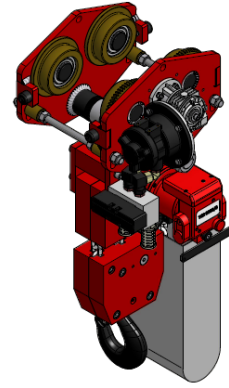
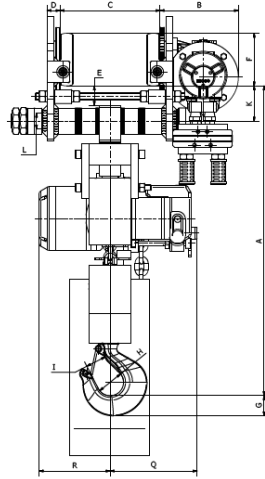
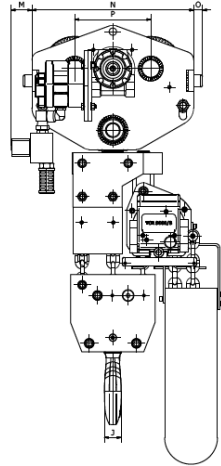

A	B	C	D	E	F∅	G	H	I	J	K	L	M	N	O	P	Q	R
~940	~223	TBA	37	55	150	60	75	53	42	100	45	59	460	25	216	247	202

**TCR12000/4-AT/4**

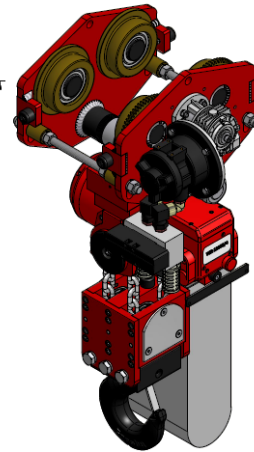
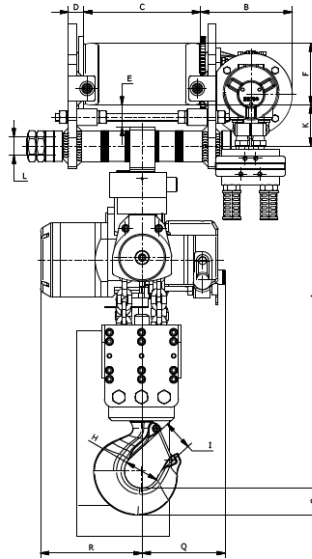
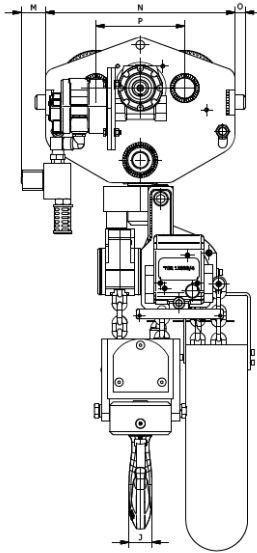

A	B	C	D	E	F∅	G	H	I	J	K	L	M	N	O	P	Q	R
~940	~223	TBC	37	55	150	67	84	58	52	100	45	59	460	25	216	247	202

**TCR15000/5-AT/4**

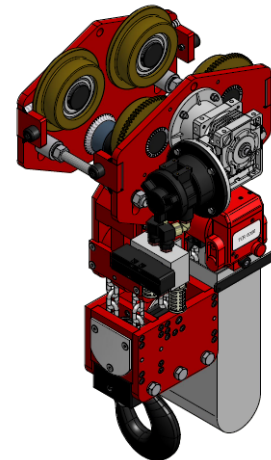
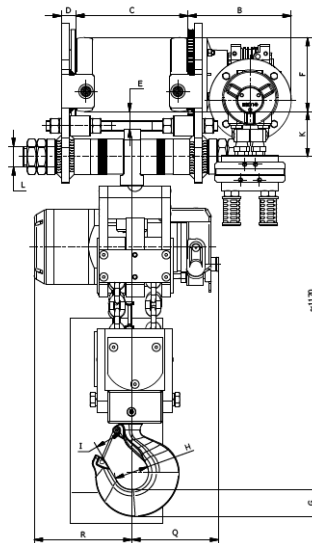
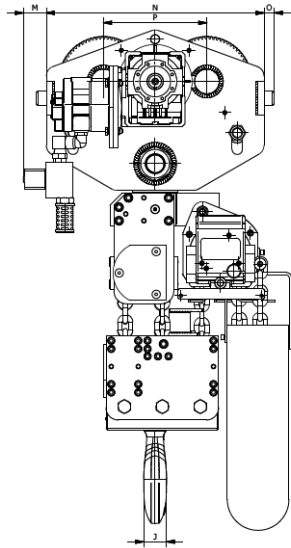

A	B	C	D	E	F∅	G	H	I	J	K	L	M	N	O	P	Q	R
~1170	~251	TBC	35	43	180	67	84	58	52	110	50	56	530	25	252	238	211

For quotation purposes only. Not drawn to scale. This drawing may not include all options offered on the quotation

**Standard Hoist Features:**

- Toku rotary vane motor.
- Robust epicyclic gearbox (grease filled and sealed).
- Failsafe automatic internal disc brake
- Choice of pendant controls or control stations
- Upper and lower limit switches.
- Cast steel housing.
- Variable speed.
- Internal silencing down to 75 dBA
- Alloy safety swivel hooks c/w safety catch.
- Load chain of European manufacture EN818/1-7
- Automatic, adjustable load limiter
- To suit various Flange Profiles
- Anti Tilt Roller & Anti Drop Plates

**Available Options:**

- Marine specification – stainless steel chain, marine paint
- Chain collectors (P.V.C., galvanised or stainless steel)
- Travel Limits
- Collision Bumpers
- Air service Units
- Festoon systems
- ATEX Specification Zone 1 & 2
- Articulated Trolley
- Low Headroom Units
- Rack & Pinion Drive
- Special Designs
- Radio Remote Control

TNC10TW-AT/4	WLL	Chain Falls	Lifting Speed Full Load (m/min)	Lifting Speed Without Load (m/min)	Air Consumption Full Load (l/sec)	Working Pressure	Air Connect	Min. Hose Diam (Bore)	Weight with 3m HOL & Trolley	Weight per metre (HOL)
Hoist	10000kg	2	1.5	2.5	90	6 bar	1 Inch BSP	1 Inch	330kg	11.4kg

TNC10TW-AT/4	WLL	Flange Size Range 1 Range 2	Travel Speed m/min	Wheel Material	Min Bend Radius	Number of Wheels	Driven Wheels	Max Air Consumption	Hose ID Trolley (Inches)
Trolley	10000kg	110-190 200-300	0-9.5	Steel	2.5	4	2	80 l/sec	1.0

TNC15TW/3-AT/4	WLL	Chain Falls	Lifting Speed Full Load (m/min)	Lifting Speed Without Load (m/min)	Air Consumption Full Load (l/sec)	Working Pressure	Air Connect	Min. Hose Diam (Bore)	Weight with 3m HOL & Trolley	Weight per metre (HOL)
Hoist	15000kg	3	1.0	1.6	90	6 bar	1 Inch BSP	1 Inch	450kg	17.1kg

TNC15TW/3-AT/4	WLL	Flange Size Range 1 Range 2	Travel Speed m/min	Wheel Material	Min Bend Radius	Number of Wheels	Driven Wheels	Max Air Consumption	Hose ID Trolley (Inches)
Trolley	15000kg	140-190 200-300	0-9.5	Steel	3.0	4	2	80 l/sec	1.0

TNC20TW/4-AT/4	WLL	Chain Falls	Lifting Speed Full Load (m/min)	Lifting Speed Without Load (m/min)	Air Consumption Full Load (l/sec)	Working Pressure	Air Connect	Min. Hose Diam (Bore)	Weight with 3m HOL & Trolley	Weight per metre (HOL)
Hoist	20000kg	4	0.75	1.25	90	6 bar	1 Inch BSP	1 Inch	670kg	22.8kg

TNC20TW/4-AT/4	WLL	Flange Size Range 1 Range 2	Travel Speed m/min	Wheel Material	Min Bend Radius	Number of Wheels	Driven Wheels	Max Air Consumption	Hose ID Trolley (Inches)
Trolley	20000kg	140-190 200-300	0-9.5	Steel	3.0	8	2	80 l/sec	1.0

For quotation purposes only. Not drawn to scale. This drawing may not include all options offered on the quotation

**red rooster** Industrial (UK) Limited.

Nauta House, The Meadows, Oldmeldrum, Aberdeenshire, AB51 0EZ, Tel: 0044 (0) 1651 872101, Fax: 0044 (0) 1651 871405, [sales@riuk.com](mailto:sales@riuk.com), [www.riuk.com](http://www.riuk.com)



**TNC10TW-AT14**

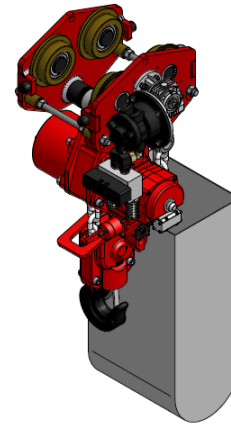
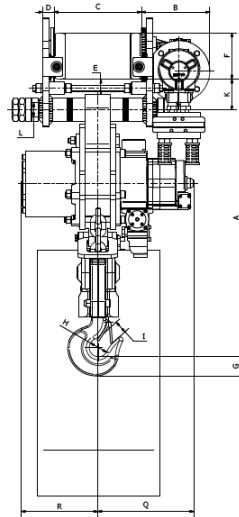
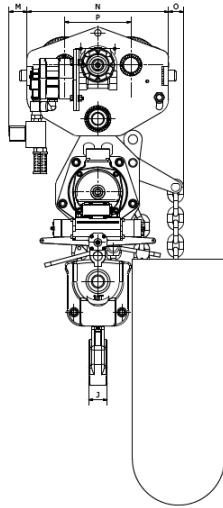

A	B	C	D	E	F $\varnothing$	G	H	I	J	K	L	M	N	O	P	Q	R
~904	~223	TBC	37	50	150	62	60	40	60	100	45	59	460	49	216	313	249

**TNC15TWI3-AT14**

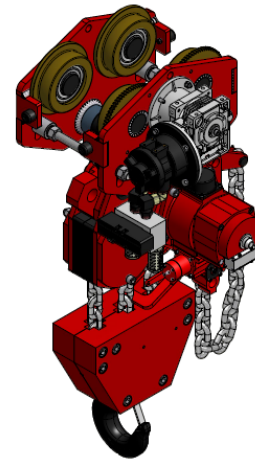
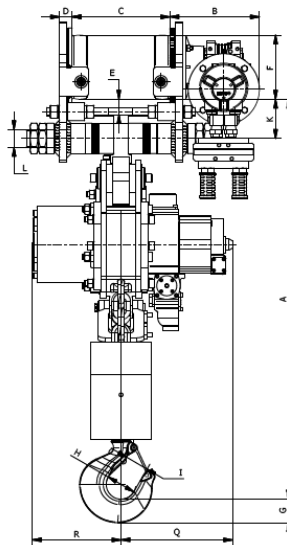
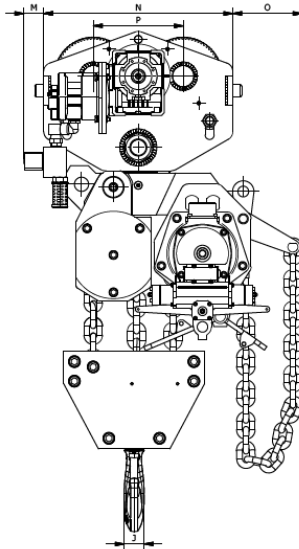

A	B	C	D	E	F $\varnothing$	G	H	I	J	K	L	M	N	O	P	Q	R
~1121	~251	TBC	35	43	180	67	84	58	52	110	50	56	530	194	252	249	313

**TNC20TWI4-AT14**

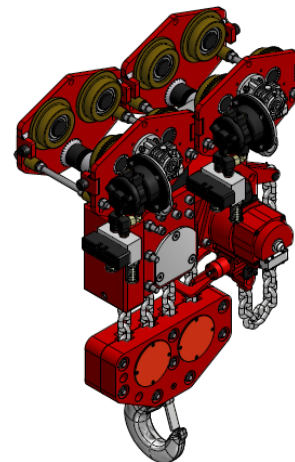
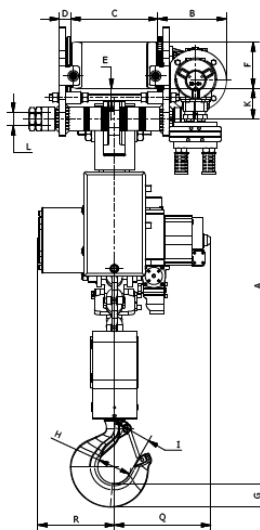
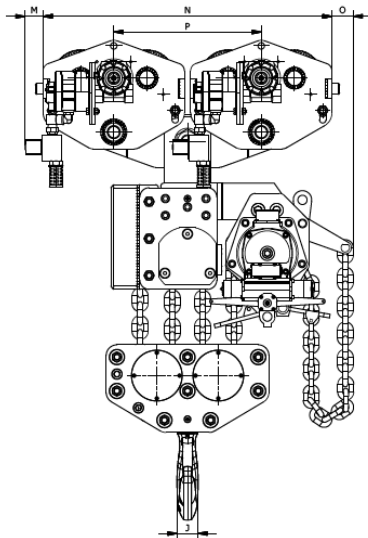

A	B	C	D	E	F $\varnothing$	G	H	I	J	K	L	M	N	O	P	Q	R
~1215	~223	TBC	37	45	150	80	110	78	64	100	45	59	940	69	480	313	249

For quotation purposes only. Not drawn to scale. This drawing may not include all options offered on the quotation



**Standard Hoist Features:**

- Toku rotary vane motor.
- Robust epicyclic gearbox (grease filled and sealed).
- Failsafe automatic internal disc brake
- Choice of pendant controls or control stations
- Upper and lower limit switches.
- Cast steel housing.
- Variable speed.
- Internal silencing down to 75 dBA
- Alloy safety swivel hooks c/w safety catch.
- Load chain of European manufacture EN818/1-7
- Automatic, adjustable load limiter
- To suit various Flange Profiles
- Anti Tilt Roller & Anti Drop Plates

**Available Options:**

- Marine specification – stainless steel chain, marine paint
- Chain collectors (P.V.C., galvanised or stainless steel)
- Travel Limits
- Collision Bumpers
- Air service Units
- Festoon systems
- ATEX Specification Zone 1 & 2
- Articulated Trolley
- Low Headroom Units
- Rack & Pinion Drive
- Special Designs
- Radio Remote Control

TNC25TW-AT/4	WLL	Chain Falls	Lifting Speed Full Load (m/min)	Lifting Speed Without Load (m/min)	Air Consumption Full Load (l/sec)	Working Pressure	Air Connect	Min. Hose Diam (Bore)	Weight with 3m HOL & Trolley	Weight per metre (HOL)
Hoist	25000kg	2	0.6	1.0	90	6 bar	1 Inch BSP	1 Inch	660kg	21.8kg

TNC25TW-AT/4	WLL	Flange Size Range 1 Range 2	Travel Speed m/min	Wheel Material	Min Bend Radius	Number of Wheels	Driven Wheels	Max Air Consumption	Hose ID Trolley (Inches)
Trolley	25000kg	140-190 200-300	0-4.0	Steel	3.0m	4	2	80 l/sec	1.0

TNC25TW-AT/8	WLL	Chain Falls	Lifting Speed Full Load (m/min)	Lifting Speed Without Load (m/min)	Air Consumption Full Load (l/sec)	Working Pressure	Air Connect	Min. Hose Diam (Bore)	Weight with 3m HOL & Trolley	Weight per metre (HOL)
Hoist	25000kg	2	0.6	1.0	90	6 bar	1 Inch BSP	1 Inch	820kg	21.8kg

TNC25TW-AT/8	WLL	Flange Size Range 1 Range 2	Travel Speed m/min	Wheel Material	Min Bend Radius	Number of Wheels	Driven Wheels	Max Air Consumption	Hose ID Trolley (Inches)
Trolley	25000kg	140-190 200-300	0-9.5	Steel	Straight only	8	4	100 l/sec	1.0

For quotation purposes only. Not drawn to scale. This drawing may not include all options offered on the quotation

## TNC25TW-AT14

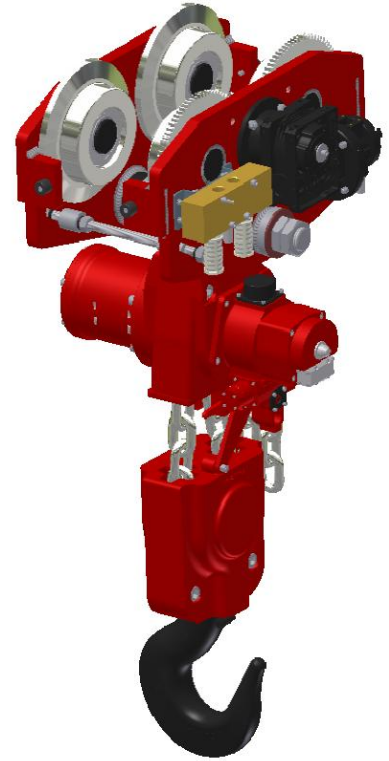
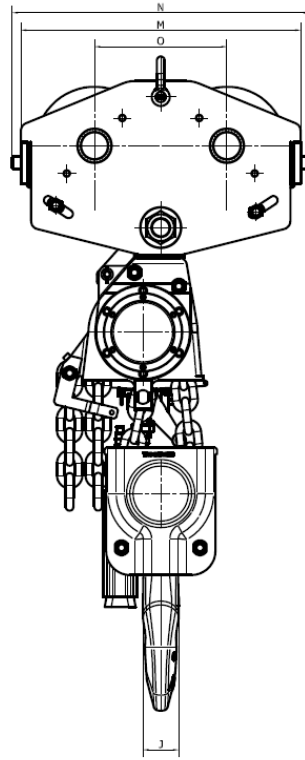
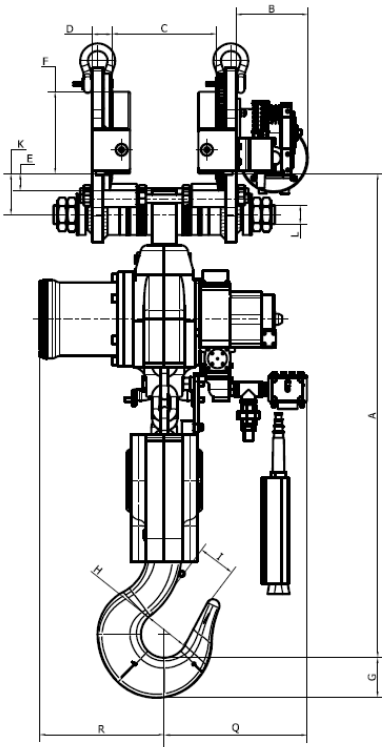

A	B	C	D	E	F∅	G	H	I	J	K	L	M	N	O	Q	R
~1418	~211	TBC	57	50	240	116	130	109	104	120	56	820	870	388	418	366

## TNC25TW-AT18

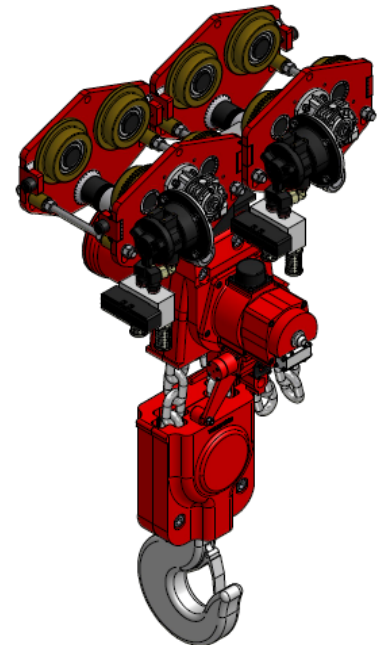
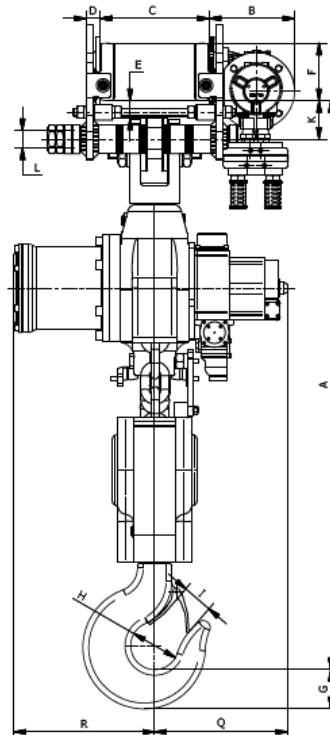
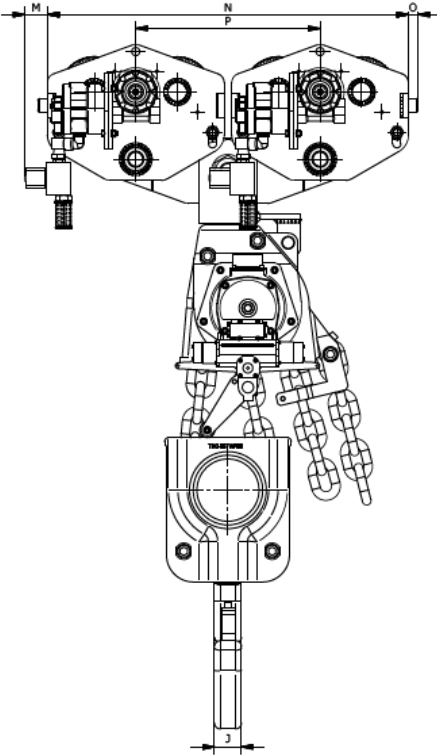

A	B	C	D	E	F∅	G	H	I	J	K	L	M	N	O	P	Q	R
~1375	~223	TBC	37	45	150	103	125	80	70	100	45	59	940	69	480	346	366

For quotation purposes only. Not drawn to scale. This drawing may not include all options offered on the quotation





**Standard Hoist Features:**

- Toku rotary vane motor.
- Robust epicyclic gearbox (grease filled and sealed).
- Failsafe automatic internal disc brake
- Choice of pendant controls or control stations
- Upper and lower limit switches.
- Cast steel housing.
- Variable speed.
- Internal silencing down to 75 dBA
- Alloy safety swivel hooks c/w safety catch.
- Load chain of European manufacture EN818/1-7
- Automatic, adjustable load limiter
- To suit various Flange Profiles
- Anti Tilt Roller & Anti Drop Plates

**Available Options:**

- Marine specification – stainless steel chain, marine paint
- Chain collectors (P.V.C., galvanised or stainless steel)
- Travel Limits
- Collision Bumpers
- Air service Units
- Festoon systems
- ATEX Specification Zone 1 & 2
- Articulated Trolley
- Low Headroom Units
- Rack & Pinion Drive
- Special Designs
- Radio Remote Control

TNC35TW-AT/8	WLL	Chain Falls	Lifting Speed Full Load (m/min)	Lifting Speed Without Load (m/min)	Air Consumption Full Load (l/sec)	Working Pressure	Air Connect	Min. Hose Diam (Bore)	Weight with 3m HOL & Trolley	Weight per metre (HOL)
Hoist	35000kg	3	0.4	0.6	90	6 bar	1 Inch BSP	1 Inch	1300kg	32.7kg

TNC35TW-AT/8	WLL	Flange Size Range 1 Range 2	Travel Speed m/min	Wheel Material	Min Bend Radius	Number of Wheels	Driven Wheels	Max Air Consumption	Hose ID Trolley (Inches)
Trolley	35000kg	140-190 200-300	0-6.3	Steel	Strait only	8	4	150 l/sec	1.25

TNC35TW-AT/225	WLL	Chain Falls	Lifting Speed Full Load (m/min)	Lifting Speed Without Load (m/min)	Air Consumption Full Load (l/sec)	Working Pressure	Air Connect	Min. Hose Diam (Bore)	Weight with 3m HOL & Trolley	Weight per metre (HOL)
Hoist	35000kg	3	0.4	0.6	90	6 bar	1 Inch BSP	1 Inch	1300kg	32.7kg

TNC35TW-AT/225	WLL	Flange Size Range 1 Range 2	Travel Speed m/min	Wheel Material	Min Bend Radius	Number of Wheels	Driven Wheels	Max Air Consumption	Hose ID Trolley (Inches)
Trolley	35000kg	140-190 200-300	0-6.3	Steel	Strait only	8	4	150 l/sec	1.25

For quotation purposes only. Not drawn to scale. This drawing may not include all options offered on the quotation



**TNC35TW-AT18**

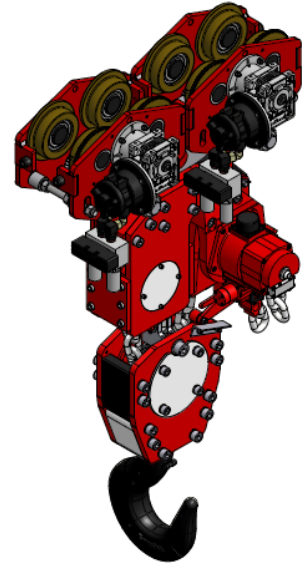
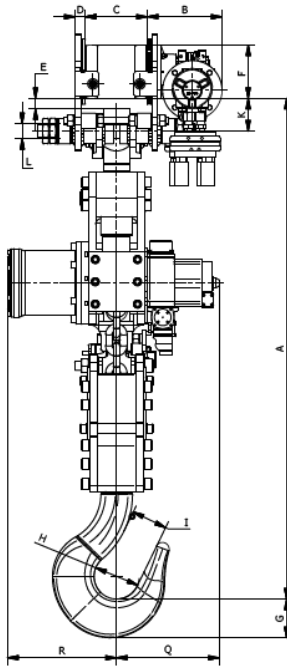
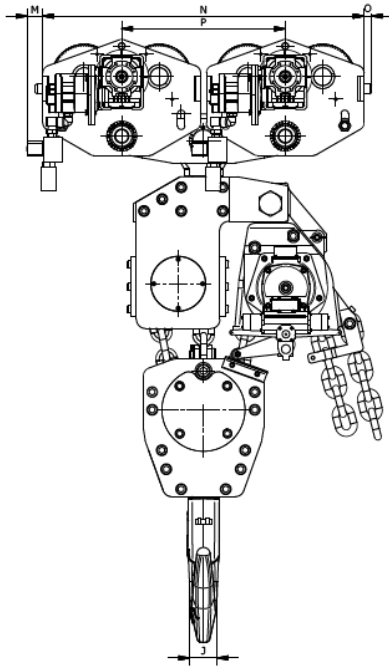

A	B	C	D	E	F $\emptyset$	G	H	I	J	K	L	M	N	O	P	Q	R
~1685	~251	TBC	35	35	180	118	140	100	95	110	50	53	1080	25	550	346	366

**TNC35TW-AT1225**

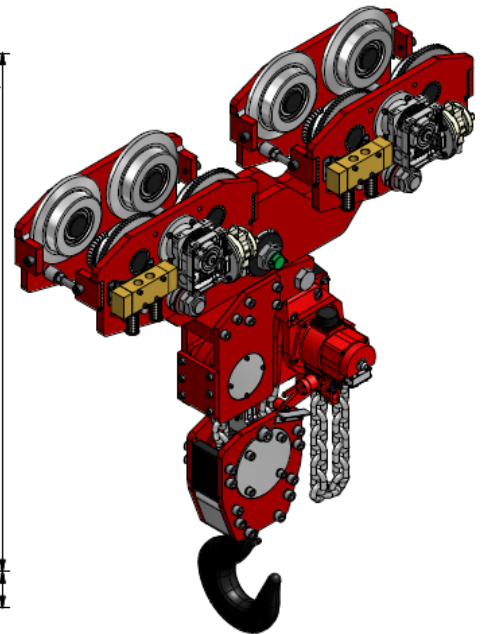
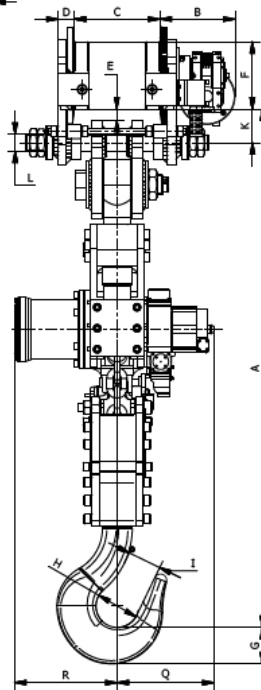
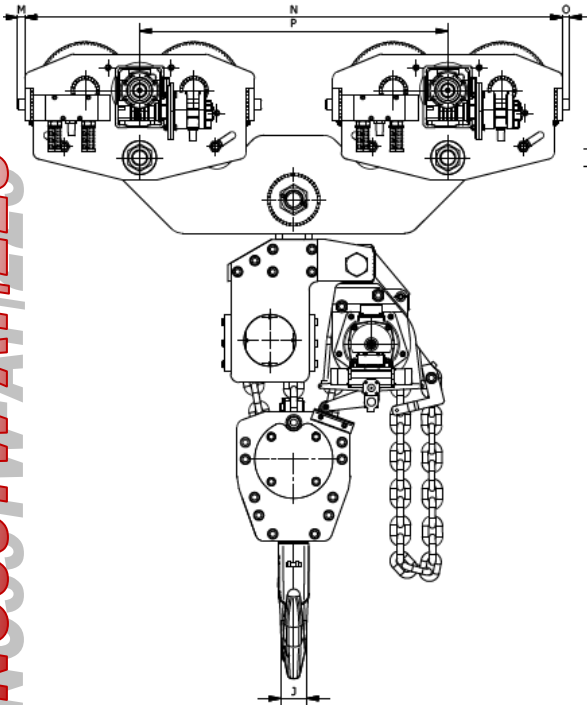

A	B	C	D	E	F $\emptyset$	G	H	I	J	K	L	M	N	O	P	Q	R
~1850	~268	TBA	57	40	240	118	140	100	95	120	60	25	1920	25	1100	346	366

For quotation purposes only. Not drawn to scale. This drawing may not include all options offered on the quotation



**Standard Hoist Features:**

- Toku rotary vane motor.
- Robust epicyclic gearbox (grease filled and sealed).
- Failsafe automatic internal disc brake
- Choice of pendant controls or control stations
- Upper and lower limit switches.
- Cast steel housing.
- Variable speed.
- Internal silencing down to 75 dBA
- Alloy safety swivel hooks c/w safety catch.
- Load chain of European manufacture EN818/1-7
- Automatic, adjustable load limiter
- To suit various Flange Profiles
- Anti Tilt Roller & Anti Drop Plates

**Available Options:**

- Marine specification – stainless steel chain, marine paint
- Chain collectors (P.V.C., galvanised or stainless steel)
- Travel Limits
- Collision Bumpers
- Air service Units
- Festoon systems
- ATEX Specification Zone 1 & 2
- Articulated Trolley
- Low Headroom Units
- Rack & Pinion Drive
- Special Designs
- Radio Remote Control
- Shackle Bottom Fitting

TNC50TW/4-AT/8	WLL	Chain Falls	Lifting Speed Full Load (m/min)	Lifting Speed Without Load (m/min)	Air Consumption Full Load (l/sec)	Working Pressure	Air Connect	Min. Hose Diam (Bore)	Weight with 3m HOL & Trolley	Weight per metre (HOL)
Hoist	50,000kg	4	0.3	0.45	90	6 bar	1 Inch BSP	1 Inch	1800	43.6kg

TNC50TW/4-AT/8	WLL	Flange Size Range 1 Range 2	Travel Speed m/min	Wheel Material	Min Bend Radius	Number of Wheels	Driven Wheels	Max Air Consumption	Hose ID Trolley (Inches)
Trolley	50,000kg	140-190 200-300	0-4.0	Steel	Strait only	8	4	150 l/sec	1.25

TNC50TW/4-AT/16	WLL	Chain Falls	Lifting Speed Full Load (m/min)	Lifting Speed Without Load (m/min)	Air Consumption Full Load (l/sec)	Working Pressure	Air Connect	Min. Hose Diam (Bore)	Weight with 3m HOL & Trolley	Weight per metre (HOL)
Hoist	50,000kg	4	0.3	0.45	90	6 bar	1 Inch BSP	1 Inch	2250	43.6kg

TNC50TW/4-AT/16	WLL	Flange Size Range 1 Range 2	Travel Speed m/min	Wheel Material	Min Bend Radius	Number of Wheels	Driven Wheels	Max Air Consumption	Hose ID Trolley (Inches)
Trolley	50,000kg	140-190 200-300	0-4.0	Steel	Strait only	16	8	200 l/sec	1.5

For quotation purposes only. Not drawn to scale. This drawing may not include all options offered on the quotation



**TNC50TWI4-AT18**

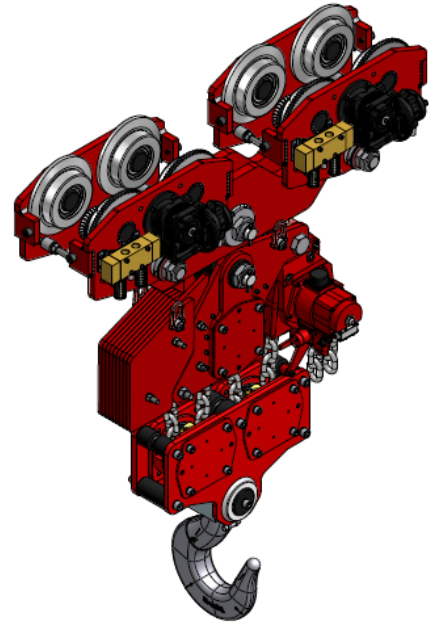
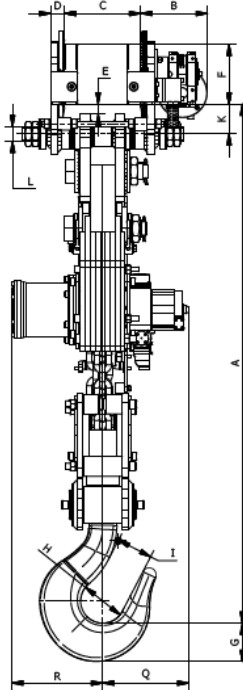
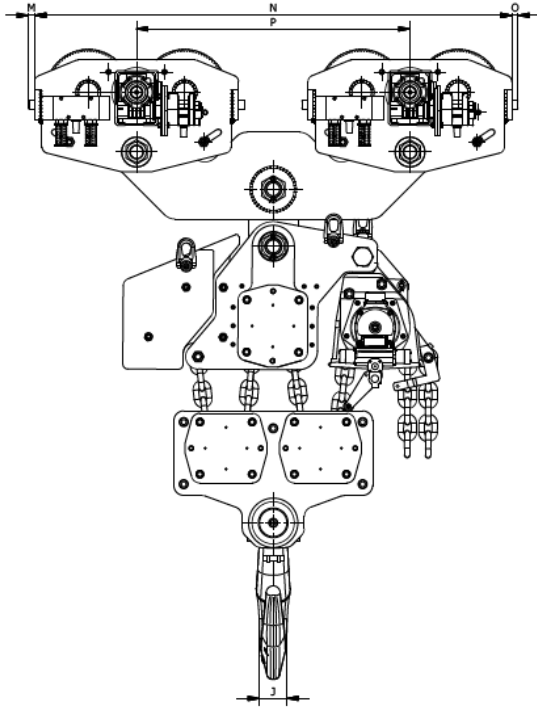

A	B	C	D	E	F $\varnothing$	G	H	I	J	K	L	M	N	O	P	Q	R
~2087	268	TBC	57	40	240	132	140	100	106	120	60	25	1920	25	1100	346	366

**TNC50TWI4-AT16**

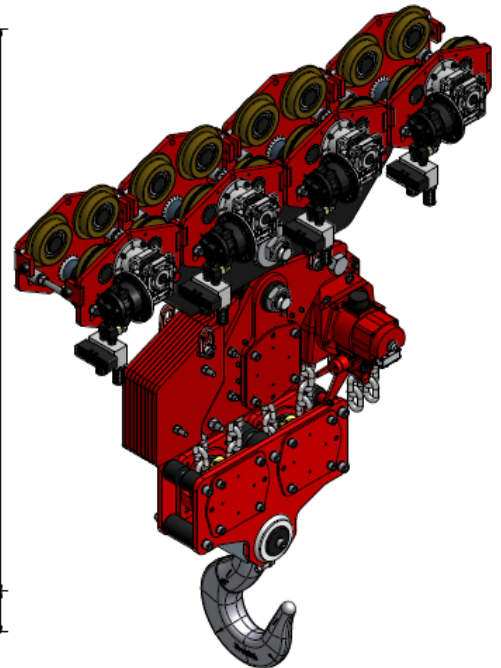
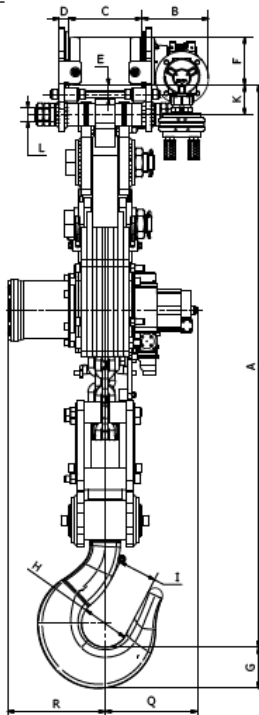
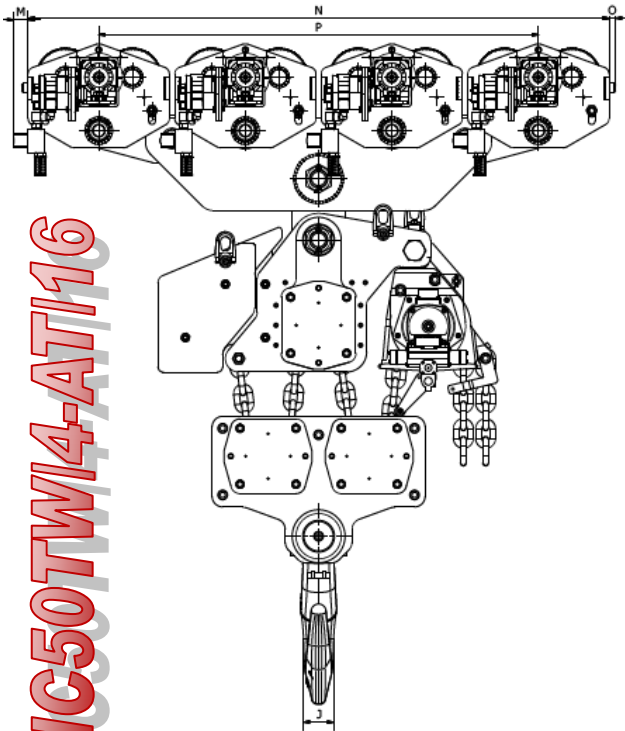

A	B	C	D	E	F $\varnothing$	G	H	I	J	K	L	M	N	O	P	Q	R
~2107	251	TBC	35	50	180	132	140	100	106	110	60	56	2180	25	1650	346	366

For quotation purposes only. Not drawn to scale. This drawing may not include all options offered on the quotation



**red rooster**  
INDUSTRIAL (UK) LTD

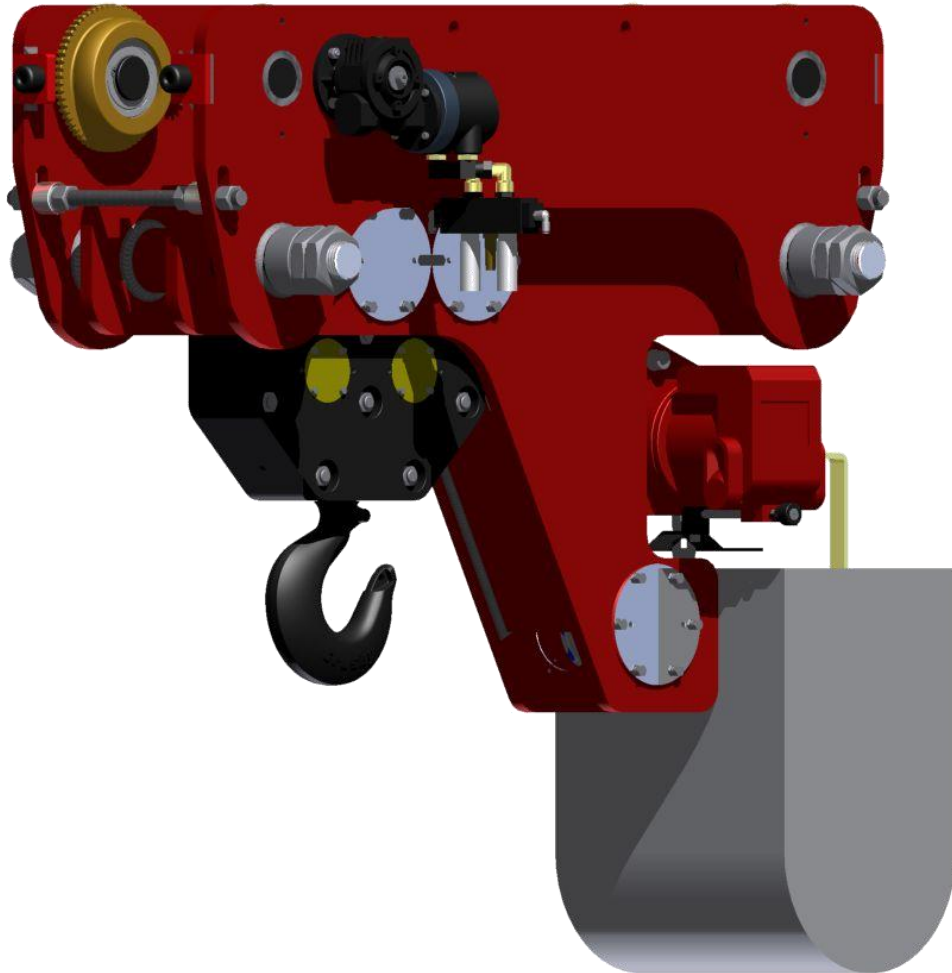

# **PNEUMATIC LOW HEADROOM HOIST & TROLLEY RANGE**

[www.rriuk.com](http://www.rriuk.com)



**A comprehensive range of quality pneumatic hoists built into Low Headroom Trolley Frames suitable for industrial and marine environments. With our in-house design team and manufacturing facilities, we can build special units to meet your requirements – such as bag handling hoists, ultra low headroom units and overhead pneumatic cranes.**

### Standard Hoist Features:

- Toku rotary vane motor
- Robust epicyclical gearbox (grease filled and sealed)
- Failsafe Automatic Internal Disc Brake
- Choice of Pull Cord or Pendant Control
- Mechanical Upper and Lower Limit Switches
- Cast Steel Housing
- Internal Silencing down to 75 dBA
- Alloy Safety Swivel Hooks c/s Safety Catch
- Load Chain of European Manufacture to EN818/1-7
- Automatic, Adjustable Load Limiter

### Available Options

- Marine Specification
- ATEX Zone 1 & 2
- Travel Limits
- Collision Bumpers
- Air Service Units
- Festoon Systems
- Articulated Trolleys
- Rack & Pinion Drive
- Special Designs
- Radio Remote Control
- Special Paint Systems

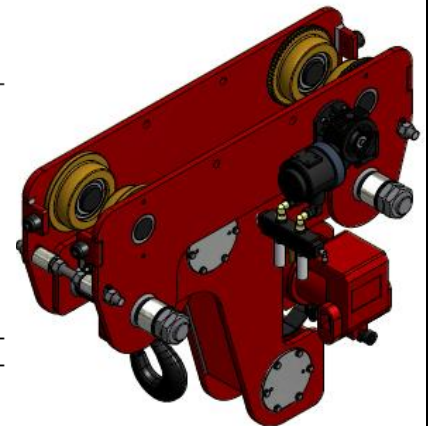
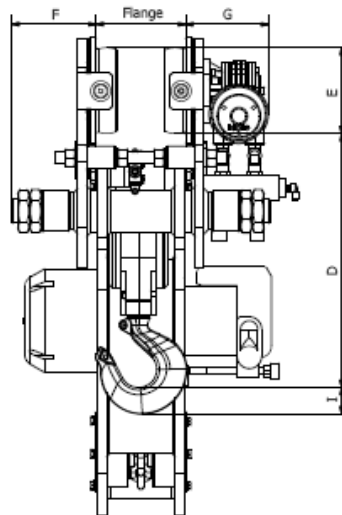
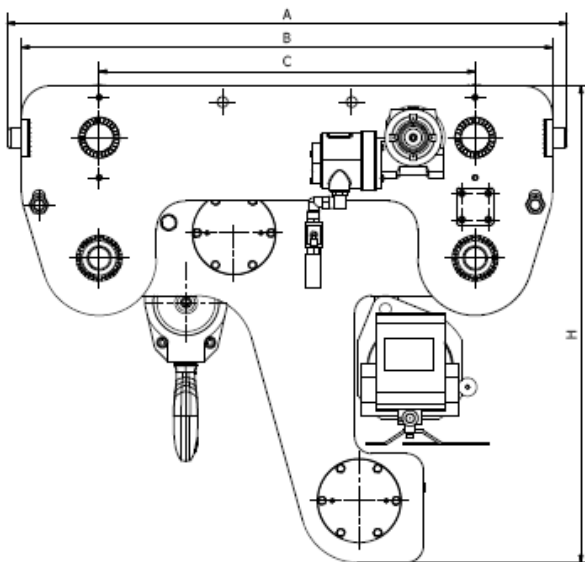

MODEL	WLL	CHAIN FALLS	LIFTING SPEED FULL LOAD	LIFTING SPEED WITHOUT LOAD	AIR CONSUM.	TRAVEL SPEED M/MIN	TROLLEY AIR CONSUM.
TCR1000-LHR	1t	1	6.0	11.3	25 l/sec	0 – 9.5	25 l/sec
TCR2000-LHR	2t	2	3	5.7	25 l/sec	0 – 9.5	25 l/sec
TCR3000-LHR	3t	1	2.8	5.7	33 l/sec	0 – 9.5	25 l/sec
TCR6000-LHR	6t	2	1.4	2.9	33 l/sec	0 – 9.5	25 l/sec
TCR12000-LHR	10t / 12t	4	0.6	1.4	33 l/sec	0 – 9.5	50 l/sec

(operating pressure = 6 bar)

MODEL	A	B	C	D	E	F	G	H
TCR1000-LHR	612	520	400	305	70	137	111	656
TCR2000-LHR	612	520	400	369	70	137	111	656
TCR3000-LHR	975	925	655	370	150	147	145	872
TCR6000-LHR	975	925	655	475	150	147	145	872
TCR12000-LHR	1235	1185	655	622	150	153	153	872

(all measurements are approximate and in mm.)

For quotation purposes only. Not drawn to scale. This drawing may not include all options offered on the quotation



**A comprehensive range of quality pneumatic hoists built into Low Headroom Trolley Frames suitable for industrial and marine environments. With our in-house design team and manufacturing facilities, we can build special units to meet your requirements – such as bag handling hoists, ultra low headroom units and overhead pneumatic cranes.**

### Standard Hoist Features:

- Toku rotary vane motor
- Robust epicyclical gearbox (grease filled and sealed)
- Failsafe Automatic Internal Disc Brake
- Choice of Pull Cord or Pendant Control
- Mechanical Upper and Lower Limit Switches
- Cast Steel Housing
- Internal Silencing down to 75 dBA
- Alloy Safety Swivel Hooks c/s Safety Catch
- Load Chain of European Manufacture to EN818/1-7
- Automatic, Adjustable Load Limiter

### Available Options

- Marine Specification
- ATEX Zone 1 & 2
- Travel Limits
- Collision Bumpers
- Air Service Units
- Festoon Systems
- Articulated Trolleys
- Rack & Pinion Drive
- Special Designs
- Radio Remote Control
- Special Paint Systems

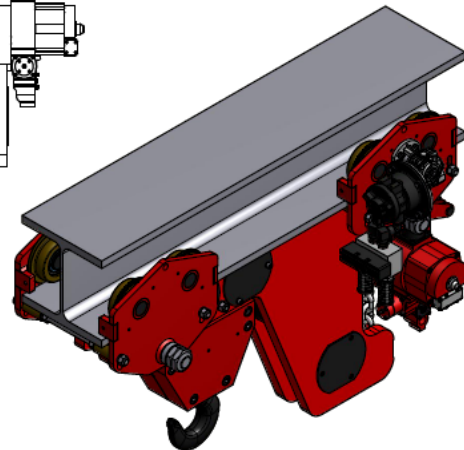
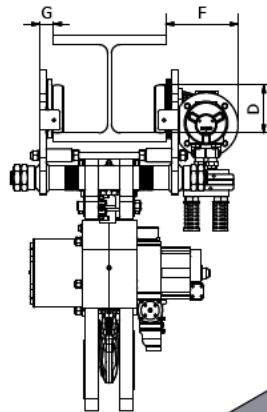
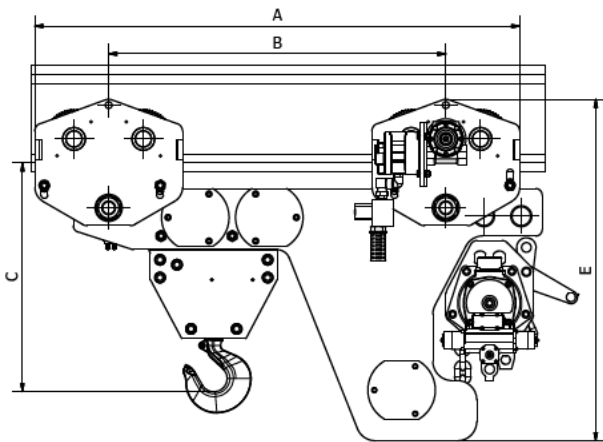

MODEL	WLL	CHAIN FALLS	LIFTING SPEED FULL LOAD	LIFTING SPEED WITHOUT LOAD	AIR CONSUM.	TRAVEL SPEED M/MIN	TROLLEY AIR CONSUM.
TNC12/4-LHR	12t	4	0.6	1.4	33 l/sec	0 – 9.5	50 l/sec
TNC15/3-LHR	15t	3	1.0	1.6	90 l/sec	0 – 9.5	100 l/sec
TNC20/4-LHR	20t	4	0.75	1.25	90	0 – 6.3	100 l/sec
TNC25/5-LHR	25t	5	0.6	1.0	90	0 – 6.3	100 l/sec

(operating pressure = 6 bar)

MODEL	A	B	C	D	E	F	G
TNC12/4-LHR	1460	900	700	150	600	225	153
TNC15/3-LHR	1310	770	710	150	880	253	147
TNC20/4-LHR	1310	770	760	180	930	260	150
TNC25/5-LHR	1561	1208	950	180	930	260	150

(all measurements are approximate and in mm.)

For quotation purposes only. Not drawn to scale. This drawing may not include all options offered on the quotation



***Various designs of hoists are available, and can be design for your special application***

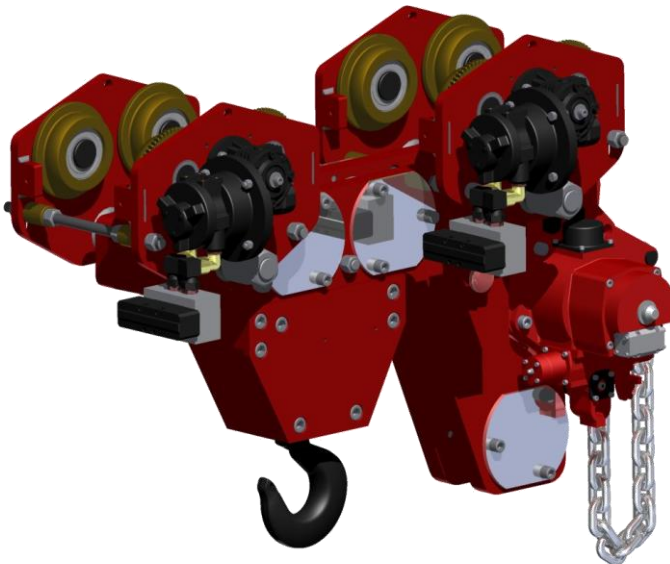
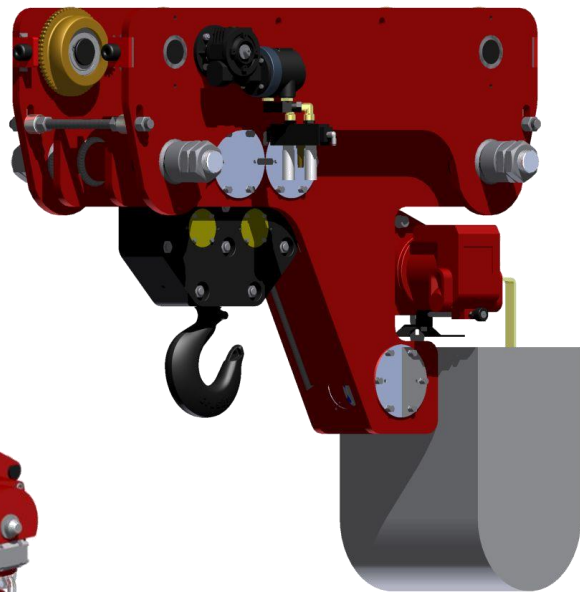
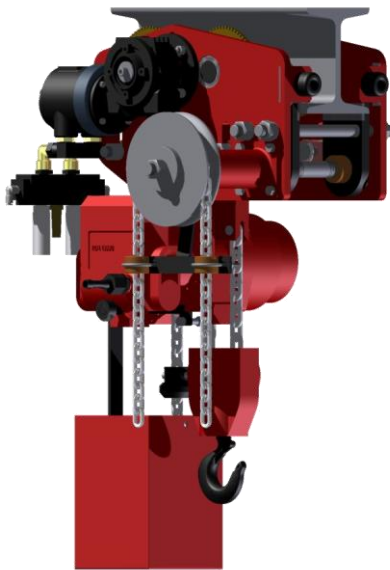
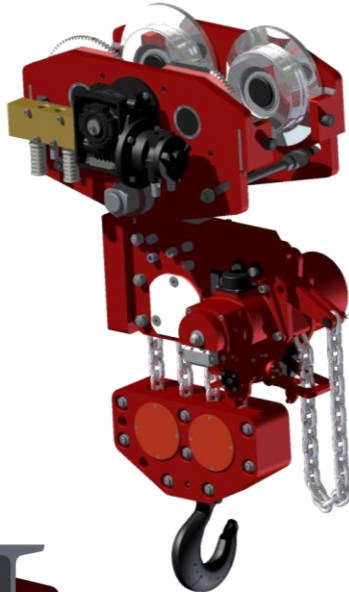
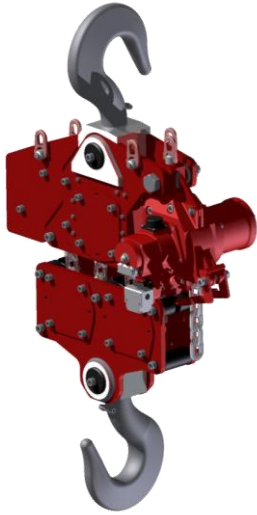



## **SPECIAL DESIGN HOISTS**

### **SPECIAL BAG HANDLING HOIST**

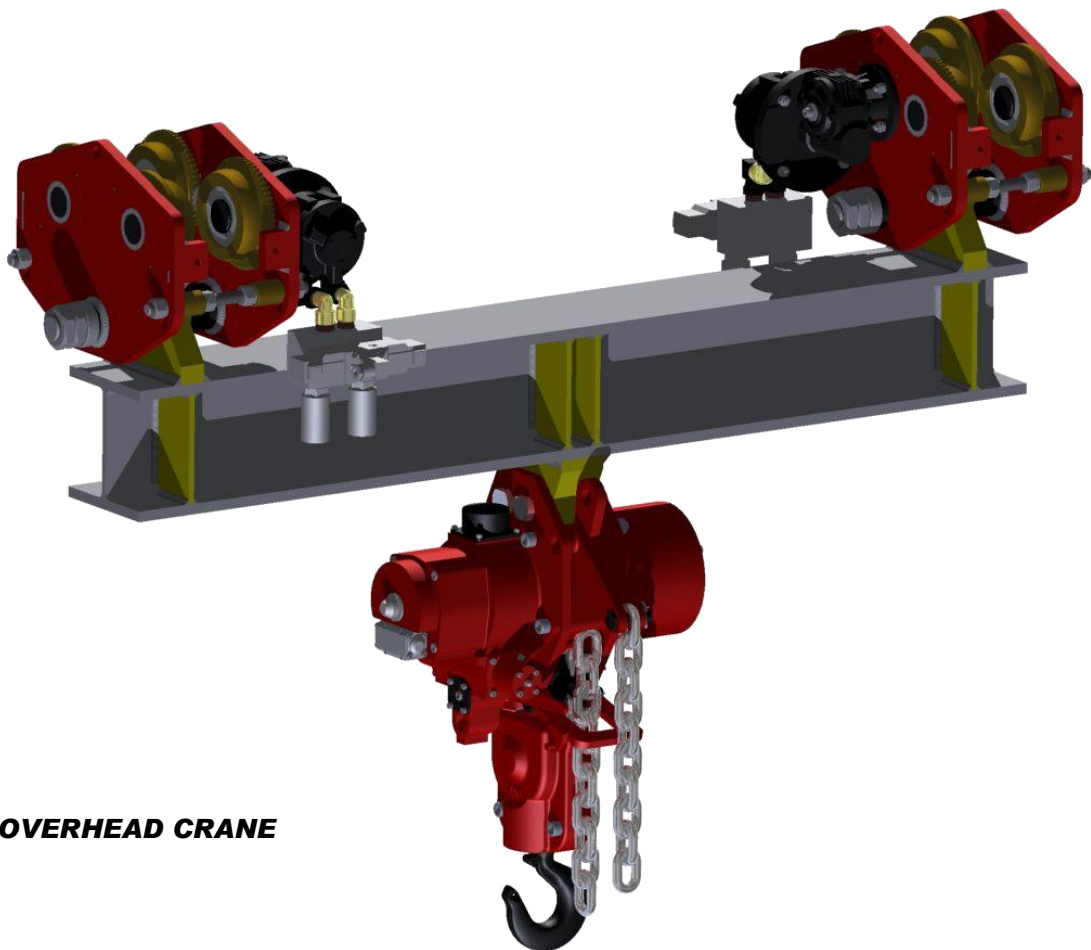
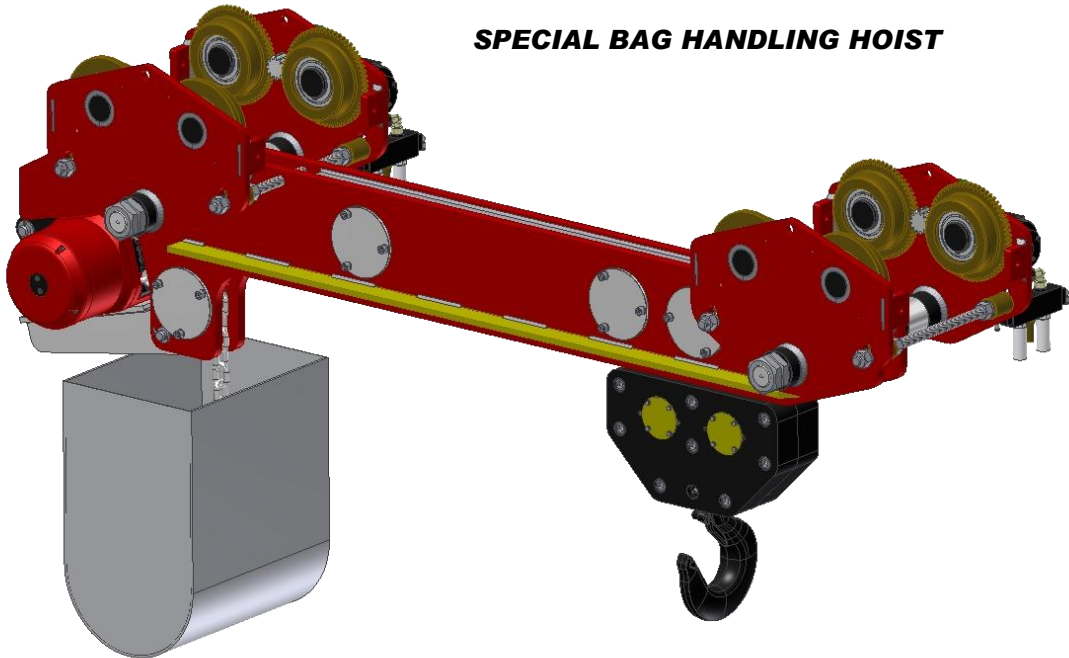

### **10t OVERHEAD CRANE**

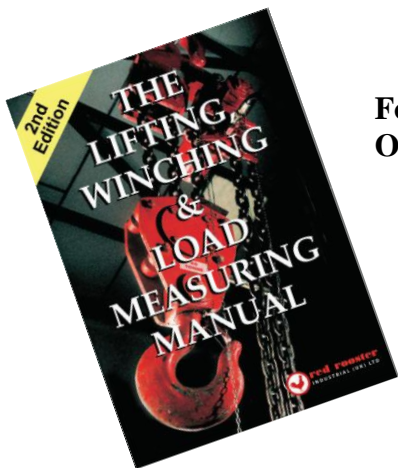

For a downloadable copy of our full catalogue, please visit  
Our website: [www.rriuk.com](http://www.rriuk.com)



**red rooster**  
**INDUSTRIAL (UK) LTD**

**Head Office:**

Nauta House  
The Meadows  
Oldmeldrum  
Aberdeenshire  
Scotland AB51 0EZ  
Tel +44 (0) 1651 872101  
Fax +44 (0) 1651 871405

**Depot:**

Unit 36,  
Kelvin Way Trading Estate  
Kelvin Way  
West Bromwich  
England B70 7TP  
Tel +44 (0) 121 525 4162  
Fax +44 (0) 121 580 4161

General Sales Email: [sales@rriuk.com](mailto:sales@rriuk.com)

[www.rriuk.com](http://www.rriuk.com)