

Sulgurkonks kahvel KHSWP klass 12

Tootekirjeldus



General: Application for general lifting.

Material: Alloy steel grade 12.

Marking: Pewag or PW, winner pro or 12, H16, CE, batch code and type.

Safety factor: 4:1.

Finish: Light blue powdercoated.

WARNING! Not to be heat-treated.

... [Read more](#)

Materjal: Eriteras klass 12. Termiliselt mitte töödelda

Märgistus: Vastavalt standardile, CE-tähisega, Vastavalt standardile, CE-tähisega

Temperatuuri vahemik: -60°C up to +300°C

Standard: EN 1677-2

Ohutustegur: 4:1

Klass: 12

Sulgurkonks kahvel KHSWP klass 12

Blueprint

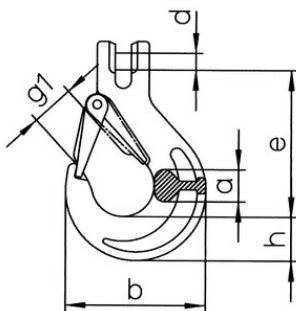

Tehnilised andmed

Tootekood	Kood	WLL tonn	LC kN	Efektiivne tööpikkus	a mm	b mm	d mm	e mm	g1mm mm	h mm	Kaal kg
403300240030	KHSWP 7	2,36	47	105	19	101	9	105	36	26	0,85
403300300030	KHSWP 8	3	60	105	19	101	10	105	36	26	0,85
403300500030	KHSWP 10	5	100	121	26	118	14	121	41	33	1,68
403300800030	KHSWP 13	8	160	148	30	147	17	148	49	43	2,99
403301250030	KHSWP 16	12,5	-	173	35	176	21	173	59	51	5,1