

## Trossi happekindel keermega otsik

---

### Tootekirjeldus

Ilma pressimiseta, kohapeal paigatatav trossi terminal keermega.

Otsiku paigaldamiseks trossile on vajalikud tavalised mutrivõtmed.

... [Read more](#)



---

**Materjal:** Happekindel teras AISI 316.

**Temperatuuri vahemik:** -50°C kuni +100°C ja lühiajaliselt kuni +200°C

**Pinnakate:** Poleeritud

## Trossi happekindel keermega otsik

### Blueprint

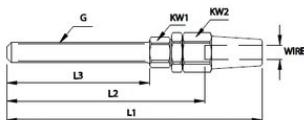

### Tehnilised andmed

| Tootekood  | Trossi Ø mm | MBL tonn | Keere     | G keere mm | L1 mm | L2 mm | L3 mm | KW1 mm | KW2 mm | Kaal kg/100tk |
|------------|-------------|----------|-----------|------------|-------|-------|-------|--------|--------|---------------|
| 1207810305 | 3           | 0,75     | M5 Left   | M5         | 79    | 58    | 42    | 10     | 12     | 4,2           |
| 1207800305 | 3           | 0,75     | M5 Right  | M5         | 79    | 58    | 42    | 10     | 12     | 4,2           |
| 1207810306 | 3           | 0,75     | M6 Left   | M6         | 85    | 63    | 47    | 10     | 12     | 4,5           |
| 1207800306 | 3           | 0,75     | M6 Right  | M6         | 85    | 63    | 47    | 10     | 12     | 4,5           |
| 1207810406 | 4           | 1,2      | M6 Left   | M6         | 92    | 63    | 47    | 12     | 14     | 5,6           |
| 1207800406 | 4           | 1,2      | M6 Right  | M6         | 92    | 63    | 47    | 12     | 14     | 5,6           |
| 1207810408 | 4           | 1,5      | M8 Left   | M8         | 102   | 72    | 57    | 12     | 14     | 6,6           |
| 1207800408 | 4           | 1,5      | M8 Right  | M8         | 102   | 72    | 57    | 12     | 14     | 6,6           |
| 1207810508 | 5           | 2,18     | M8 Left   | M8         | 111   | 78    | 57    | 13     | 16     | 9             |
| 1207800508 | 5           | 2,18     | M8 Right  | M8         | 111   | 78    | 57    | 13     | 16     | 9             |
| 1207810510 | 5           | 2,18     | M10 Left  | M10        | 117   | 84    | 63    | 13     | 16     | 10            |
| 1207800510 | 5           | 2,18     | M10 Right | M10        | 117   | 84    | 63    | 13     | 16     | 10            |
| 1207810610 | 6           | 3,5      | M10 Left  | M10        | 128   | 90    | 63    | 16     | 19     | 15            |
| 1207800610 | 6           | 3,5      | M10 Right | M10        | 128   | 90    | 63    | 16     | 19     | 15            |
| 1207810612 | 6           | 3,7      | M12 Left  | M12        | 145   | 107   | 80    | 16     | 19     | 17            |
| 1207800612 | 6           | 3,7      | M12 Right | M12        | 145   | 107   | 80    | 16     | 19     | 17            |
| 1207810712 | 7           | 4,7      | M12 Left  | M12        | 153   | 110   | 80    | 18     | 21     | 22            |
| 1207800712 | 7           | 4,7      | M12 Right | M12        | 153   | 110   | 80    | 18     | 21     | 22            |
| 1207810714 | 7           | 4,7      | M14 Left  | M14        | 162   | 119   | 89    | 18     | 21     | 25            |
| 1207800714 | 7           | 4,7      | M14 Right | M14        | 162   | 119   | 89    | 18     | 21     | 25            |
| 1207810812 | 8           | 5,1      | M12 Left  | M12        | 162   | 113   | 80    | 19     | 24     | 28            |
| 1207800812 | 8           | 5,1      | M12 Right | M12        | 162   | 113   | 80    | 19     | 24     | 28            |

## Trossi happekindel keermega otsik

### Tehnilised andmed

| Tootekood  | Trossi Ø mm | MBL tonn | Keere     | G keere mm | L1 mm | L2 mm | L3 mm | KW1 mm | KW2 mm | Kaal kg/100tk |
|------------|-------------|----------|-----------|------------|-------|-------|-------|--------|--------|---------------|
| 1207810814 | 8           | 5,6      | M14 Left  | M14        | 171   | 122   | 89    | 19     | 24     | 31            |
| 1207800814 | 8           | 5,6      | M14 Right | M14        | 171   | 122   | 89    | 19     | 24     | 31            |
| 1207810816 | 8           | 5,6      | M16 Left  | M16        | 182   | 133   | 100   | 19     | 24     | 40            |
| 1207800816 | 8           | 5,6      | M16 Right | M16        | 182   | 133   | 100   | 19     | 24     | 40            |
| 1207811016 | 10          | 8,3      | M16 Left  | M16        | 190   | 139   | 100   | 24     | 27     | 48            |
| 1207801016 | 10          | 8,3      | M16 Right | M16        | 190   | 139   | 100   | 24     | 27     | 48            |
| 1207811220 | 12          | 12       | M20 Left  | M20        | 227   | 159   | 120   | 27     | 32     | 79            |
| 1207801220 | 12          | 12       | M20 Right | M20        | 227   | 159   | 120   | 27     | 32     | 79            |
| 1207811422 | 14          | 17       | M22 Left  | M22        | 264   | 191   | 140   | 30     | 36     | 124           |
| 1207801422 | 14          | 17       | M22 Right | M22        | 264   | 191   | 140   | 30     | 36     | 124           |
| 1207811624 | 16          | 21       | M24 Left  | M24        | 308   | 227   | 170   | 32     | 41     | 175           |
| 1207801624 | 16          | 21       | M24 Right | M24        | 308   | 227   | 170   | 32     | 41     | 175           |