

## Green Pin tõsteseekel Super G-5263

### Tootekirjeldus

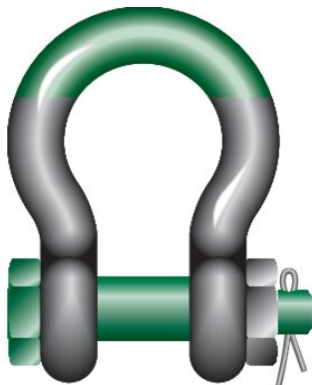

- **General:** Bow shackles with safety bolt.

- **Standard:** Meets performance requirements of US Fed. Spec. RR-C-271 Type IVA Class 3, Grade B.

- **Temperature range:** -20°C up to +200°C.

- **Certification:** At no extra charges this product can be supplied with works certificate, 3.1 material certificate, manufacturer test certificate, EC Declaration of Conformity. All shackles starting from 150 tons are supplied with a Lloyd's Register of Shipping Certificate on proof load. [... Read more](#)

**Materjal:** Bow and pin alloy steel, Grade 8, quenched and tempered.

**Märgistus:** CE-tähisega

**Pinnakate:** Hot dipped galvanized (175 ton shackle is painted).

**Ohutustegur:** 5:1

**Klass:** 8

## Green Pin tõsteseekel Super G-5263

### Blueprint

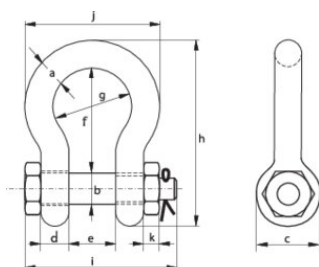

### Tehnilised andmed

Tootekood	WLL tonn	a mm	b mm mm	c mm	d mm mm	e mm mm	f mm mm	g mm mm	h mm mm	i mm mm	j mm mm	k mm mm	Kaal kg
420100330590	3,3	13,5	16	34	13	22	51	32	90	80	59	13	0,4
420100500590	5	16	19	40	16	27	64	43	110	98	75	17	0,73
420100700590	7	19	22	46	19	31	76	51	129	115	89	19	1,19
420100950590	9,5	22	25	52	22	36	83	58	144	130	102	22	1,73
420101250590	12,5	25	28	59	25	43	95	68	164	150	118	25	2,56
420101500590	15	28	32	67	28	47	108	75	186	166	131	27	3,6
420101800590	18	32	35	73	32	51	115	83	201	184	147	30	4,95
420102100590	21	35	38	79	35	57	133	92	227	197	162	33	6,62
420103000590	30	38	42	88	38	60	146	99	249	202	175	19	8,11
420104000590	40	45	50	104	45	74	178	126	300	243	216	23	14,8
420105500590	55	57	57	119	57	83	197	138	342	283	252	26	23,3
420108500590	85	70	70	145	70	105	260	180	438	339	320	32	45,1
420112000590	120	83	83	164	83	127	329	190	537	397	356	39	72
420115000590	150	95	95	204	95	147	400	238	644	453	428	50	116
420117500590	175	105	108	235	105	169	410	275	686	496	485	50	156