

Clevis Sling Hook Pewag KHSWP

Product information



The forged safety catch locks into the tip of the hook, thereby providing excellent protection against lateral shifts. The safety catch mechanism and the clevis load pins are available as spare parts sets and easy and quick to exchange by a competent person.

The forged control markings make it easy to determine discard criteria [... Read more](#)

Material: Alloy steel

Marking: According to standard, CE-marked, Pewag or PW, winner pro or 12, H16, batch code and type.

Temperature range: -60°C up to +300°C.

Finish: Light blue powdercoated.

Standard: EN 1677-2

Warning: Not to be heat-treated.

Safety factor: 4:1

Grade: 12

Clevis Sling Hook Pewag KHSWP

Blueprint

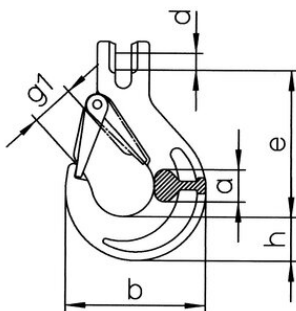

Technical data

Part code	Code	WLL ton	LC kN	EWL	a mm	b mm	d mm	e mm	g1mm mm	h mm	Weight kg
403300240030	KHSWP 7	2.36	47	105	19	101	9	105	36	26	0.85
403300300030	KHSWP 8	3	60	105	19	101	10	105	36	26	0.85
403300500030	KHSWP 10	5	100	121	26	118	14	121	41	33	1.68
403300800030	KHSWP 13	8	160	148	30	147	17	148	49	43	2.99
403301250030	KHSWP 16	12.5	-	173	35	176	21	173	59	51	5.1