

## Swageless Terminal with Thread

---

### Product information

Swageless stainless thread terminal for safe, reliable and machine free self assembly.

... [Read more](#)



---

**Material:** Stainless steel AISI 316.

**Temperature range:** -50°C to +100°C and briefly up to +200°C

**Finish:** High polished.

**Warning:** Read assembly instructions before use!

## Swageless Terminal with Thread

### Blueprint

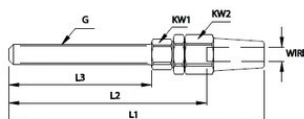

### Technical data

Part code	Rope Ø range mm	MBL ton	Thread	G thread mm	L1 mm	L2 mm	L3 mm	KW1 mm	KW2 mm	Weight kg/100pc
1207810305	3	0.75	M5 Left	M5	79	58	42	10	12	4.2
1207800305	3	0.75	M5 Right	M5	79	58	42	10	12	4.2
1207810306	3	0.75	M6 Left	M6	85	63	47	10	12	4.5
1207800306	3	0.75	M6 Right	M6	85	63	47	10	12	4.5
1207810406	4	1.2	M6 Left	M6	92	63	47	12	14	5.6
1207800406	4	1.2	M6 Right	M6	92	63	47	12	14	5.6
1207810408	4	1.5	M8 Left	M8	102	72	57	12	14	6.6
1207800408	4	1.5	M8 Right	M8	102	72	57	12	14	6.6
1207810508	5	2.18	M8 Left	M8	111	78	57	13	16	9
1207800508	5	2.18	M8 Right	M8	111	78	57	13	16	9
1207810510	5	2.18	M10 Left	M10	117	84	63	13	16	10
1207800510	5	2.18	M10 Right	M10	117	84	63	13	16	10
1207810610	6	3.5	M10 Left	M10	128	90	63	16	19	15
1207800610	6	3.5	M10 Right	M10	128	90	63	16	19	15
1207810612	6	3.7	M12 Left	M12	145	107	80	16	19	17
1207800612	6	3.7	M12 Right	M12	145	107	80	16	19	17
1207810712	7	4.7	M12 Left	M12	153	110	80	18	21	22
1207800712	7	4.7	M12 Right	M12	153	110	80	18	21	22
1207810714	7	4.7	M14 Left	M14	162	119	89	18	21	25
1207800714	7	4.7	M14 Right	M14	162	119	89	18	21	25
1207810812	8	5.1	M12 Left	M12	162	113	80	19	24	28
1207800812	8	5.1	M12 Right	M12	162	113	80	19	24	28

## Swageless Terminal with Thread

### Technical data

Part code	Rope Ø range mm	MBL ton	Thread	G thread mm	L1 mm	L2 mm	L3 mm	KW1 mm	KW2 mm	Weight kg/100pc
1207810814	8	5.6	M14 Left	M14	171	122	89	19	24	31
1207800814	8	5.6	M14 Right	M14	171	122	89	19	24	31
1207810816	8	5.6	M16 Left	M16	182	133	100	19	24	40
1207800816	8	5.6	M16 Right	M16	182	133	100	19	24	40
1207811016	10	8.3	M16 Left	M16	190	139	100	24	27	48
1207801016	10	8.3	M16 Right	M16	190	139	100	24	27	48
1207811220	12	12	M20 Left	M20	227	159	120	27	32	79
1207801220	12	12	M20 Right	M20	227	159	120	27	32	79
1207811422	14	17	M22 Left	M22	264	191	140	30	36	124
1207801422	14	17	M22 Right	M22	264	191	140	30	36	124
1207811624	16	21	M24 Left	M24	308	227	170	32	41	175
1207801624	16	21	M24 Right	M24	308	227	170	32	41	175