

Stainless steel connecting link

Product information

Connecting link is used for connecting short link chains to different components in a lifting sling.

... [Read more](#)



Material: AISI 316

Marking: CE-marked

Temperature range: -40 - (+)400°C

Warning: Not to be heat-treated

Safety factor: 4:1

Stainless steel connecting link

Blueprint

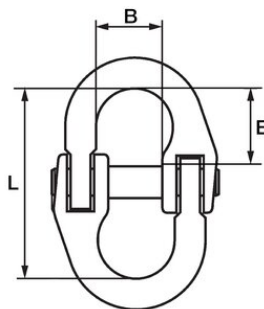

Technical data

Part code	WLL ton	For chain Ø mm	E mm	B mm	L mm	Weight kg
400200070080	0.7	6	14	16	45	0.1
400200120080	1.2	8	18	20	55	0.16
400200160080	1.6	10	25	25	73	0.36
400200270080	2.7	13	32	28	92	0.73