

Clevis Safety Hook Pewag KLHWP

Product information



KLHWP Clevis safety hook closes and locks automatically under load.

... [Read more](#)

Material: Alloy steel.

Marking: According to standard, CE-marked, Pewag or PW, winner pro or 12, H16, batch code and type.

Temperature range: -60°C up to +300°C.

Finish: Light blue powdercoated.

Standard: EN 1677-3

Warning: Not to be heat-treated.

Safety factor: 4:1

Grade: 12

Clevis Safety Hook Pewag KLHWP

Blueprint

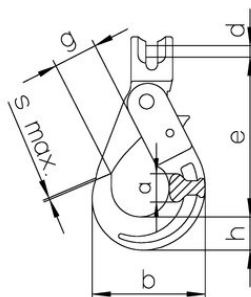

Technical data

| Part code | Code | WLL ton | EWL | a mm | b mm | d mm | e mm | g mm | h mm | s max. mm | Weight kg |
|--------------|----------|---------|-----|------|------|------|------|------|------|-----------|-----------|
| 403300240090 | KLHWP 7 | 2.36 | 116 | 23.6 | 90 | 9.5 | 116 | 32 | 24,5 | 1 | 0.89 |
| 403300300090 | KLHWP 8 | 3 | 115 | 23.6 | 90 | 10.7 | 115 | 32 | 24,5 | 1 | 0.9 |
| 403300500090 | KLHWP 10 | 5 | 136 | 27.8 | 113 | 14 | 136 | 45 | 31,5 | 1 | 1.6 |
| 403300800090 | KLHWP 13 | 8 | 179 | 33.7 | 146 | 17.5 | 179 | 54 | 39,8 | 1.5 | 3.42 |