

## Farm hook, grade 80

---

### Product information

For e.g. lifting large bags

... [Read more](#)

---



**Material:** Steel

**Marking:** According to standard, CE-marked

**Temperature range:** -40 - (+)200°C / 400°C = WLL 75%

**Finish:** Painted, yellow

**Standard:** EN 1677-1

**Warning:** Not to be heat-treated

**Safety factor:** 4:1

**Grade:** 8

## Farm hook, grade 80

### Blueprint

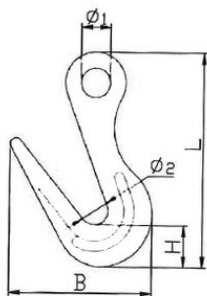

### Technical data

Part code	WLL ton	EWL mm	$\varnothing 1$ mm	B mm	$\varnothing 2$ mm	L mm	H, mm	Weight kg
401300200590	2	195	35	170	33	254	49	3.1