

Master Link Assembly MC1 POWERTEX

Product information



The POWERTEX Master Link assembly MC1 is part of the range of Powertex G10 Lifting Sling Chain Components. The MC1 assembly is made up of a master link and an integrated connector with a shortening hook. This convenient combination allows operators to easily adjust the assembly length according to the specific application requirements. Due to its integrated components, this part is more cost-efficient, user-friendly, and lightweight than traditional assemblies. The MC-1 is to be used for one leg chain sling assemblies.

Available for 6 mm up to 16 mm chain and from WLL 1,4t up to WLL 10t. All models have a welded master link and forged connector.

Also available as MC2 for two-legged assemblies and MC4 for four-legged assemblies.

Powerdex G10 Range benefits:

- 25% higher capacity compared to traditional Grade 8 components
- All POWERTEX G10 components are powder painted in luminous red
- Multi-functional master links and components are included in the range to allow quick and cost-effective assembly of chain slings
- The components meet EN 1677 part 1/2/3/4 +25% WLL
- Each forged component is crack detection tested, and samples are proof load tested.
- Each component is type tested in the factory and fatigue rated to 20,000 cycles at 1.5 times the WLL
- Full traceability through a batch number
- Replacement spare parts available
- All components are chromium 6 free
- POWERTEX 2.2 certificate enclosed with each box of components ... [Read more](#)

Marking: According to standard, POWERTEX + Model (MC1-6-10) + traceability code.

Temperature range: -40°C up to +200°C without reduction in WLL

Finish: Powder painted in luminous red

Standard: EN 1677-4 (+25% WLL) , AS 3776

Note: All models are welded

Safety factor: 4:1

Grade: 10

Master Link Assembly MC1 POWERTEX

Blueprint

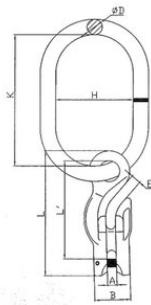

Technical data

Part code	Code	WLL ton	EWL mm	For chain, 1-leg mm	A mm	B mm	D mm	E mm	H mm	K mm	L mm	L' mm	Weight kg
402100140790	MC1-6-10	1.4	198	6	8	32	13	8	60	110	112	88	1.24
402100250790	MC1-8-10	2.5	236	8	10	36	14	10	70	120	145	116	1.81
402100400790	MC1-10-10	4	285	10	12.5	48	17	12.5	80	140	184	145	3.41
402100670790	MC1-13-10	6.7	338	13	15.5	59.5	22	15.5	95	160	223	178	6.2
402101000790	MC1-16-10	10	406	16	19	70	25	19	110	190	273	216	11.25