

## Dee Shackle SC Green Pin® Pin G-4151

### Product information



The Green Pin® Dee Shackle SC is a dee shackle with a screw collar pin. The screw pin enables quick (dis)assembly which makes the shackle perfect for rigging activities in which assembly and disassembly occur relatively frequently. Due to the galvanization of the shackle its long-term durability is assured. Furthermore, the shackle's design reduces the wear of (wire) rope as the screw thread is hidden in a chamber. Particularly important for use offshore, the Green Pin® Dee Shackle SC conforms to a wide range of certifications from class societies such as DNV GL. The Green Pin® Dee Shackle SC is suitable for one-leg lifting systems only and is available in a range with a working load limit from 0.33 up to 55 ton.

Certification on request: 2.1, 2.2, 3.1, MTCa, DNVGL-ST-0378, ABS PDA ARS MA  
... [Read more](#)

**Material:** Bow and pin high tensile steel, quenched and tempered

**Marking:** According to standard, CE-marked

**Temperature range:** -40°C up to +200°C

**Finish:** Hot dip galvanized

**Standard:** EN 13889

**Safety factor:** 6:1

**Grade:** 6

## Dee Shackle SC Green Pin® Pin G-4151

### Blueprint

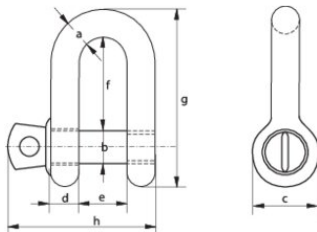

### Technical data

Part code	WLL ton	A mm	B mm	C mm	D mm	e mm	f mm	g mm	h mm	Weight kg
420100030680	0.33	5	6	12	5	9,5	19	33	29,5	0.02
420100050680	0.5	7	8	16,5	7	12	22	41,5	38	0.05
420100080680	0.75	9	10	20	9	13,5	26	50	46,5	0.09
420100100680	1	10	11	22,5	10	17	32	59	54	0.14
420100150680	1.5	11	13	26,5	11	19	37	68	59,5	0.19
420100200680	2	13,5	16	34	13	22	43	81	73	0.32
420100330680	3.25	16	19	40	16	27	51	97	89	0.54
420100480680	4.75	19	22	46	19	31	59	112	103	0.87
420100650680	6.5	22	25	52	22	36	73	134	119	1.34
420100850680	8.5	25	28	59	25	43	85	154	137	2.08
420100950680	9.5	28	32	66	28	47	90	167	153	2.77
420101200680	12	32	35	72	32	51	94	180	170	3.72
420101350680	13.5	35	38	80	35	57	115	209	186	5.14
420101700680	17	38	42	88	38	60	127	230	203	6.85
420102500680	25	45	50	103	45	74	149	271	243	11.45
420103500680	35	50	57	111	50	83	171	305	272	16.86
420104250680	42.5	57	65	130	57	95	190	345	310	24.61
420105500680	55	65	70	145	65	105	203	376	344	32.65